



**NEW!**  
**INTERACTIVE PDF**  
Click on the underlined text

[www.widinus.com\(US\)](http://www.widinus.com(US))  
[www.iwidin.com\(KR\)](http://www.iwidin.com(KR))

# LIVE CENTER

LIVE CENTER

LATHE CENTER

SPECIAL LIVE CENTER



# HOW TO MAKE LIVE CENTER CODE

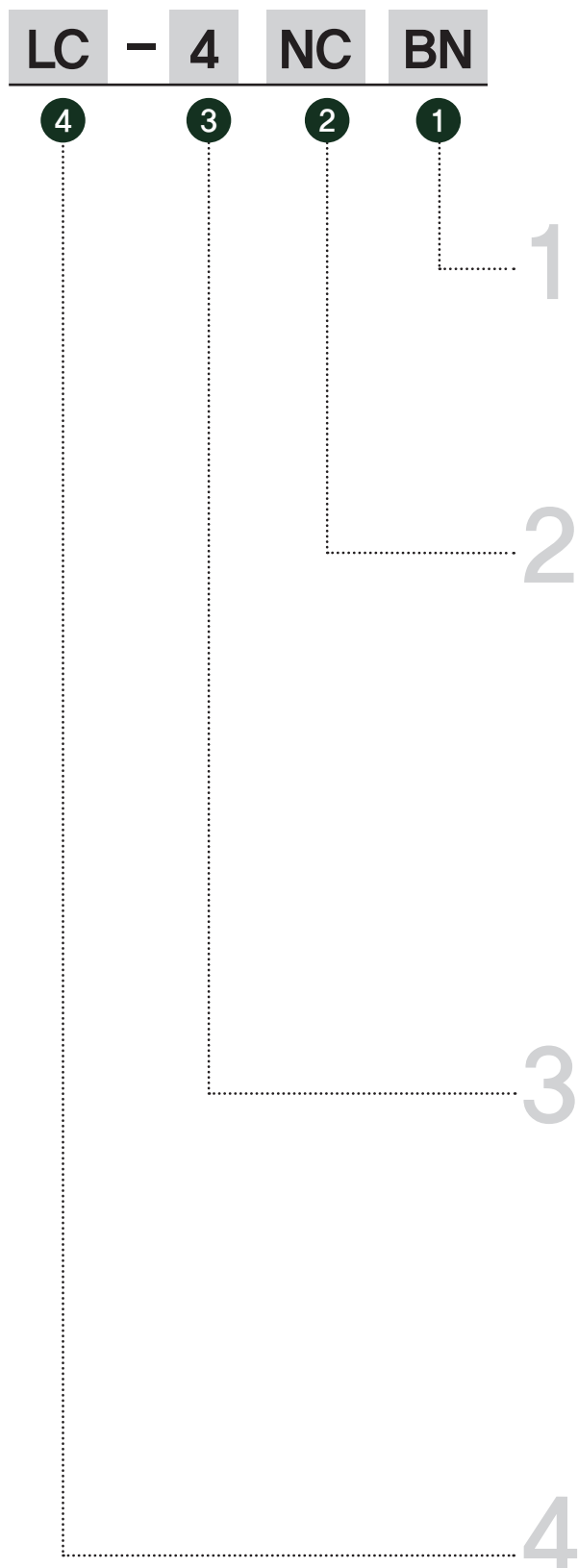

B, N	EXPANSION TYPE, NUT REMOVABLE TYPE
B	EXPANSION TYPE
C	CARBIDE TIPPED TYPE
N	NUT REMOVABLE TYPE
TH	FOR SCREWING TYPE

NC	NC TYPE MODEL
HD	ECONOMIC TYPE
NC	NC LATHE TYPE
NCP	NC TYPE HEAVY TYPE
SM	NC LATHE, HIGH SPEED ROTATION TYPE
SMP	SM TYPE HEAVY TYPE
D50	MINIMIZE THE BITE-INTERFERENCE
NK	HEAVY CUTTING, HEAVY DUTY TYPE
NKD	HEAVY, SEMI-HIGH SPEED TYPE(NK POWER TYPE)
PT	PIPE MACHINING TYPE
GR	FOR GRINDING MACHINE TYPE

4	MORSE TAPER No.4	
Mt.0	Ø9.045	1° 29' 27"
Mt.1	Ø12.065	1° 25' 43"
Mt.2	Ø17.780	1° 29' 50"
Mt.3	Ø23.825	1° 26' 16"
Mt.4	Ø31.267	1° 29' 15"
Mt.5	Ø44.399	1° 30' 26"
Mt.6	Ø63.348	1° 29' 36"
Mt.7	Ø83.058	1° 29' 22"

LC	LIVE CENTER
LC	LIVE CENTER
LM	LATHE CENTER

# LIVE CENTER CLASSIFICATION

SHAFT TURN	<b>LC-NC</b>	<ul style="list-style-type: none"> <li>· For NC Lathe machining</li> <li>· Prevention of the inflow of foreign substance</li> <li>· BN(POINT TEC.)</li> <li>· SN(NEW SERIM)</li> <li>· 60N(ROHM)</li> </ul>	
	<b>LC-NCP</b>	<ul style="list-style-type: none"> <li>· Advanced NC TYPE Model</li> <li>· BNHL30, BHSL30</li> <li>· SNA30</li> <li>· 604HVL</li> </ul>	
	<b>LC-NK</b>	<ul style="list-style-type: none"> <li>· Use for heavy cutting, heavy duty</li> </ul>	
	<b>LC-SM</b>	<ul style="list-style-type: none"> <li>· Use for high speed rotation NC lathe</li> </ul>	
	<b>LC-SMP</b>	<ul style="list-style-type: none"> <li>· Advanced SM TYPE Model</li> </ul>	
	<b>LC-GR</b>	<ul style="list-style-type: none"> <li>· For Grinding machine heavy cutting and heavy duty</li> </ul>	
	<b>LC-D50</b>	<ul style="list-style-type: none"> <li>· For NC lathe machining</li> <li>· Minimize the bite-interference</li> </ul>	
CAP TURN	<b>LC-HD</b>	<ul style="list-style-type: none"> <li>· For Wide-use Lathe</li> </ul>	
	<b>LC-HDS</b>	<ul style="list-style-type: none"> <li>· Advanced HD TYPE Model</li> </ul>	
	<b>LC-PT</b>	<ul style="list-style-type: none"> <li>· Exclusive model of PIPE Machining</li> </ul>	

# CONTENTS

## LC-NC TYPE ——— 06

- 07p NC TYPE
- 07p NCB TYPE
- 07p NCC TYPE
- 08p NCBC TYPE
- 08p NCN TYPE
- 08p NCBN TYPE
- 09p NCCN TYPE
- 09p NCBCN TYPE
- 10p NCTH TYPE
- 10p NCNTH TYPE



## LC-NCP TYPE ——— 12

- 13p NCP TYPE
- 13p NCPB TYPE
- 13p NCPN TYPE
- 14p NCPBC TYPE
- 14p NCPN TYPE
- 14p NCPBN TYPE
- 15p NCPN TYPE
- 15p NCPBCN TYPE



## LC-NK · NKD TYPE ——— 16

- 17p NK TYPE
- 17p NKB TYPE
- 17p NKC TYPE
- 18p NKBC TYPE
- 18p NKN TYPE
- 18p NKBN TYPE
- 19p NKCN TYPE
- 19p NKBCN TYPE
- 20p NKD TYPE



## LC-GR · SM TYPE ——— 21

- 21p GR TYPE
- 23p SM TYPE
- 23p SMB TYPE
- 23p SMC TYPE
- 24p SMBC TYPE
- 24p SMN TYPE
- 24p SMBN TYPE
- 25p SMCN TYPE
- 25p SMBCN TYPE



## LC-SMP TYPE ——— 26

- 27p SMP TYPE
- 27p SMPB TYPE
- 27p SMPN TYPE
- 28p SMPBC TYPE
- 28p SMPN TYPE
- 28p SMPBN TYPE
- 29p SMPN TYPE
- 29p SMPBCN TYPE



## LC-D50 TYPE ——— 30

- 31p D50 TYPE
- 31p D50B TYPE
- 31p D50C TYPE
- 32p D50BC TYPE



## LC-HD TYPE ——— 33

- 34p HD TYPE
- 34p HDC TYPE
- 34p HDS TYPE
- 35p HDSC TYPE
- 35p HDSTH TYPE



## LC-PT TYPE ————— 36

37p PT-60 TYPE  
37p PT-80 TYPE



## LM CENTER ————— 38

39p LM-A TYPE  
39p LM-C TYPE  
40p LM-AN TYPE  
40p LM-CN TYPE



## LM-H CENTER ————— 41

42p LM-H TYPE  
42p LM-HC TYPE  
43p LM-HN TYPE  
43p LM-HCN TYPE



## LM-FN CENTER ————— 44

44p LM FN CENTER



## LM-#80 TYPE ————— 45

45p LM-#80 TYPE



## FLANGE CENTER ————— 46

46p LM-G TYPE



## FACE DRIVE ————— 47

47p FDC TYPE



# LC-NC

## NC-TYPE

- ▶ Live Center for CNC Lathes
- ▶ Sealed to prevent the inflow of cutting oils and foreign substances
- ▶ High precision of rotational accuracy and durability through using the triplexed bearing structure.
- ▶ Shaft heat treated to 58-62 HRc
- ▶ RUN OUT 0.00012" or 0.003mm



### NCB TYPE

Minimize the bite-interference



### NCBC TYPE

Minimize the bite-interference  
/ Carbide Type



### NCBN TYPE

Minimize the bite-interference  
/ Nut Type



### NCBCN TYPE

Minimize the bite-interference  
/ Carbide, Nut Type



### NCC TYPE

Carbide Type



### NCN TYPE

Nut Type



### NCCN TYPE

Carbide, Nut Type



### NCTH TYPE

Screw Thread type



**New**

### NCNTH TYPE

Draw-off Nut &  
Screw Thread type



**New**



# NC-TYPE

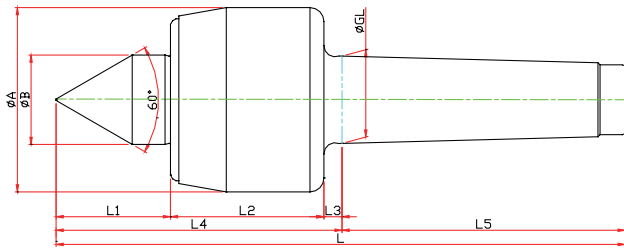

unit:mm/kg

Model	Morse Taper	Dimension									Weight Max. (lbs)	R.P.M Max.	Run out (inch)
		GL	A	B	L1	L2	L3	L4	L5	L			
<a href="#">LC-3NC</a>	NO.3	23.825	50	22	27	45	5	77	81	158	1388,91	4800	0,00011811
<a href="#">LC-4NC</a>	NO.4	31.267	66	32	41	55	6,5	102,5	101,5	204	2425,09	3800	0,00011811
<a href="#">LC-5NC</a>	NO.5	44.399	82	40	50	65	6,5	121,5	129,5	251	3527,4	3400	0,00019685
<a href="#">LC-6NC</a>	NO.6	63.384	105	45	54	80	8	142	182	324	4629,71	3000	0,00019685

※SPECIAL sizes or dimensions are available with quick turnaround

# NCB-TYPE

※ HAFT EXTENTION(Minimize the bite-interference)

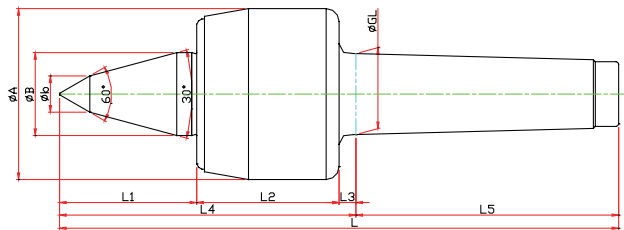

unit:mm/kg

Model	Morse Taper	Dimension										Weight Max. (lbs)	R.P.M Max.	Run out (inch)
		GL	A	B	b	L1	L2	L3	L4	L5	L			
<a href="#">LC-3NCB</a>	NO.3	23.825	50	22	10	47	45	5	97	81	178	1388,91	4800	0,00011811
<a href="#">LC-4NCB</a>	NO.4	31.267	66	32	14	53	55	6,5	114,5	101,5	216	2425,09	3800	0,00011811
<a href="#">LC-5NCB</a>	NO.5	44.399	82	40	16	65	65	6,5	129,5	129,5	266	3527,4	3400	0,00019685
<a href="#">LC-6NCB</a>	NO.6	63.384	105	45	18	78	80	8	182	182	348	4629,71	3000	0,00019685

※SPECIAL sizes or dimensions are available with quick turnaround

# NCC-TYPE

※ Carbide Type

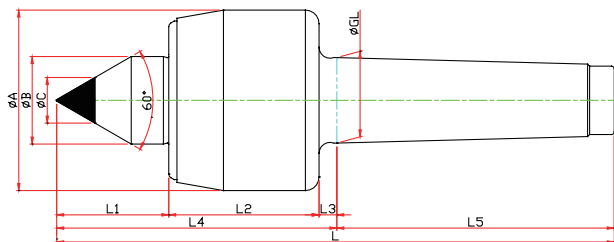

unit:mm/kg

Model	Morse Taper	Dimension										Weight Max. (lbs)	R.P.M Max.	Run out (inch)
		GL	A	B	L1	L2	L3	L4	L5	C	L			
<a href="#">LC-3NCC</a>	NO.3	23.825	50	22	27	45	5	77	81	10	158	1388,91	4800	0,00011811
<a href="#">LC-4NCC</a>	NO.4	31.267	66	32	41	55	6,5	102,5	101,5	14	204	2425,09	3800	0,00011811
<a href="#">LC-5NCC</a>	NO.5	44.399	82	40	50	65	6,5	121,5	129,5	18	251	3527,4	3400	0,00019685
<a href="#">LC-6NCC</a>	NO.6	63.384	105	45	54	80	8	142	182	25	324	4629,71	3000	0,00019685

※SPECIAL sizes or dimensions are available with quick turnaround

# NCBC-TYPE

- ※ SHAFT EXTENTION(Minimize the bite-interference)
- ※ Carbide Type

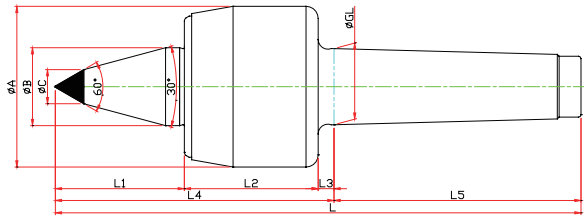

unit:mm/kg

Model	Morse Taper	Dimension										Weight Max. (lbs)	R.P.M Max.	Run out (inch)
		GL	A	B	L1	L2	L3	L4	L5	C	L			
<a href="#">LC-3NCBC</a>	NO.3	23,825	50	22	47	45	5	97	81	10	178	1388.91	4800	0.00011811
<a href="#">LC-4NCBC</a>	NO.4	31,267	66	32	53	55	6.5	114.5	101.5	14	216	2425.09	3800	0.00011811
<a href="#">LC-5NCBC</a>	NO.5	44,399	82	40	65	65	6.5	136.5	129.5	16	266	3527.4	3400	0.00019685
<a href="#">LC-6NCBC</a>	NO.6	63,384	105	45	78	80	8	166	182	18	348	4629.71	3000	0.00019685

※SPECIAL sizes or dimensions are available with quick turnaround

# NCN-TYPE

- ※ Nut Type

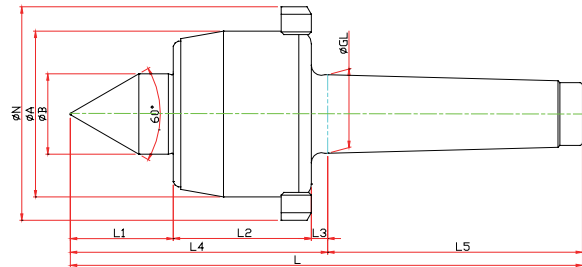

unit:mm/kg

Model	Morse Taper	Dimension										Weight Max. (lbs)	R.P.M Max.	Run out (inch)
		GL	A	B	L1	L2	L3	L4	L5	N	L			
<a href="#">LC-3NCN</a>	NO.3	23,825	50	22	27	45	5	77	81	70	158	1388.91	4800	0.00011811
<a href="#">LC-4NCN</a>	NO.4	31,267	66	32	41	55	6.5	102.5	101.5	85	204	2425.09	3800	0.00011811
<a href="#">LC-5NCN</a>	NO.5	44,399	82	40	50	65	6.5	121.5	129.5	105	251	3527.4	3400	0.00019685
<a href="#">LC-6NCN</a>	NO.6	63,384	105	45	54	80	8	142	182	130	324	4629.71	3000	0.00019685

※SPECIAL sizes or dimensions are available with quick turnaround

# NCBN-TYPE

- ※ SHAFT EXTENTION(Minimize the bite-interference)
- ※ Nut Type

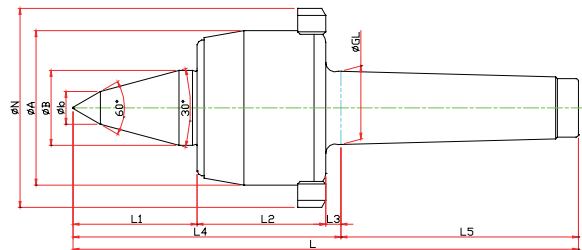

unit:mm/kg

Model	Morse Taper	Dimension											Weight Max. (lbs)	R.P.M Max.	Run out (inch)
		GL	A	B	b	L1	L2	L3	L4	L5	N	L			
<a href="#">LC-3NCBN</a>	NO.3	23,825	50	22	10	47	45	5	97	81	70	178	1388.91	4800	0.00011811
<a href="#">LC-4NCBN</a>	NO.4	31,267	66	32	14	53	55	6.5	114.5	101.5	85	216	2425.09	3800	0.00011811
<a href="#">LC-5NCBN</a>	NO.5	44,399	82	40	16	65	65	6.5	136.5	129.5	105	266	3527.4	3400	0.00019685
<a href="#">LC-6NCBN</a>	NO.6	63,384	105	45	18	78	80	8	166	182	130	348	4629.71	3000	0.00019685

※SPECIAL sizes or dimensions are available with quick turnaround



# NCCN-TYPE

※ Carbide, Nut Type

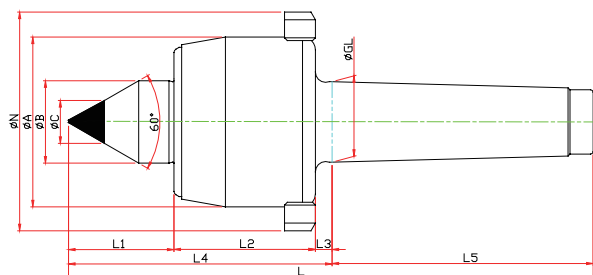

unit:mm/kg

Model	Morse Taper	Dimension											Weight Max. (lbs)	R.P.M Max.	Run out (inch)
		GL	A	B	L1	L2	L3	L4	L5	C	N	L			
<a href="#">LC-3NCCN</a>	NO.3	23.825	50	22	27	45	5	77	81	10	70	158	1388.91	4800	0.00011811
<a href="#">LC-4NCCN</a>	NO.4	31.267	66	32	41	55	6.5	102.5	101.5	14	85	204	2425.09	3800	0.00011811
<a href="#">LC-5NCCN</a>	NO.5	44.399	82	40	50	65	6.5	121.5	129.5	18	105	251	3527.4	3400	0.00019685
<a href="#">LC-6NCCN</a>	NO.6	63.384	105	45	54	80	8	142	182	25	130	324	4629.71	3000	0.00019685

※SPECIAL sizes or dimensions are available with quick turnaround

# NCBCN-TYPE

※ SHAFT EXTENTION(Minimize the bite-interference)

※ Carbide, Nut Type

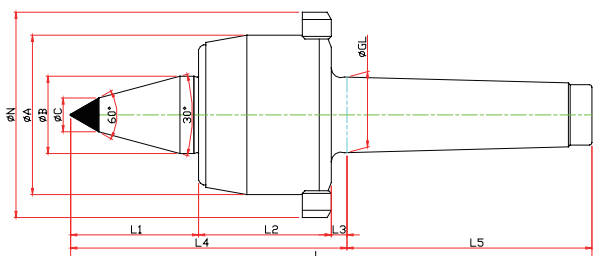

unit:mm/kg

Model	Morse Taper	Dimension											Weight Max. (lbs)	R.P.M Max.	Run out (inch)
		GL	A	B	L1	L2	L3	L4	L5	C	N	L			
<a href="#">LC-3NCBCN</a>	NO.3	23.825	50	22	47	45	5	97	81	10	70	178	1388.91	4800	0.00011811
<a href="#">LC-4NCBCN</a>	NO.4	31.267	66	32	53	55	6.5	114.5	101.5	14	85	216	2425.09	3800	0.00011811
<a href="#">LC-5NCBCN</a>	NO.5	44.399	82	40	65	65	6.5	136.5	129.5	16	105	266	3527.4	3400	0.00019685
<a href="#">LC-6NCBCN</a>	NO.6	63.384	105	45	78	80	8	166	182	18	130	348	4629.71	3000	0.00019685

※SPECIAL sizes or dimensions are available with quick turnaround

# NCTH-TYPE - Screw thread type *New*

- ※ Screw thread type, Appropriate model for NC lathes
- ※ Coolant-proof models
- ※ Triple bearing method
- ※ Appropriate RPM(below 3800)

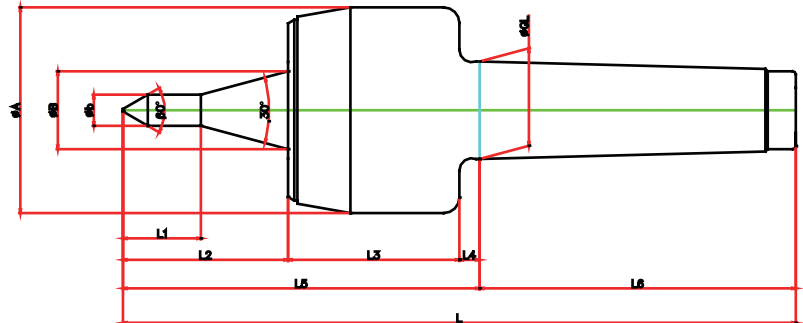

unit:mm/kg

Model	Morse Taper	Dimension											Weight Max. (lbs)	R.P.M Max.	Run out (inch)
		G	A	B	d	L1	L2	L3	L4	L5	L6	L			
<a href="#">LC-3NCTH-06</a>	Mt.3	23,825	52	22	6	16,3	50	51	5	100	81	181	992,08	4,800	0,00011811
<a href="#">LC-3NCTH-08</a>	Mt.3	23,825	52	22	8	20	50	51	5	100	81	181	992,08	4,800	0,00011811
<a href="#">LC-3NCTH-10</a>	Mt.3	23,825	52	22	10	23,7	50	51	5	100	81	181	992,08	4,800	0,00011811
<a href="#">LC-3NCTH-12</a>	Mt.3	23,825	52	22	12	27,5	50	51	5	100	81	181	992,08	4,800	0,00011811
<a href="#">LC-3NCTH-14</a>	Mt.3	23,825	52	22	14	31,2	50	51	5	100	81	181	992,08	4,800	0,00011811
<a href="#">LC-3NCTH-16</a>	Mt.3	23,825	52	22	16	34,9	50	51	5	100	81	181	992,08	4,800	0,00011811
<a href="#">LC-4NCTH-06</a>	Mt.4	31,267	66	25	6	17,5	53	55	6,5	114,5	101,5	216	1719,61	3,800	0,00011811
<a href="#">LC-4NCTH-08</a>	Mt.4	31,267	66	25	8	21,3	53	55	6,5	114,5	101,5	216	1719,61	3,800	0,00011811
<a href="#">LC-4NCTH-10</a>	Mt.4	31,267	66	25	10	25	53	55	6,5	114,5	101,5	216	1719,61	3,800	0,00011811
<a href="#">LC-4NCTH-12</a>	Mt.4	31,267	66	25	12	28,7	53	55	6,5	114,5	101,5	216	1719,61	3,800	0,00011811
<a href="#">LC-4NCTH-14</a>	Mt.4	31,267	66	25	14	32,5	53	55	6,5	114,5	101,5	216	1719,61	3,800	0,00011811
<a href="#">LC-4NCTH-16</a>	Mt.4	31,267	66	25	16	36,2	53	55	6,5	114,5	101,5	216	1719,61	3,800	0,00011811
<a href="#">LC-5NCTH-06</a>	Mt.5	44,399	82	32	6	16,5	65	65	6,5	136,5	129,5	266	2425,09	3,400	0,00019685
<a href="#">LC-5NCTH-08</a>	Mt.5	44,399	82	32	8	20,2	65	65	6,5	136,5	129,5	266	2425,09	3,400	0,00019685
<a href="#">LC-5NCTH-10</a>	Mt.5	44,399	82	32	10	23,9	65	65	6,5	136,5	129,5	266	2425,09	3,400	0,00019685
<a href="#">LC-5NCTH-12</a>	Mt.5	44,399	82	32	12	27,7	65	65	6,5	136,5	129,5	266	2425,09	3,400	0,00019685
<a href="#">LC-5NCTH-14</a>	Mt.5	44,399	82	32	14	31,4	65	65	6,5	136,5	129,5	266	2425,09	3,400	0,00019685
<a href="#">LC-5NCTH-16</a>	Mt.5	44,399	82	32	16	35,1	65	65	6,5	136,5	129,5	266	2425,09	3,400	0,00019685

※SPECIAL sizes or dimensions are available with quick turnaround

# NCNTH-TYPE - Screw thread type & Draw-off Nut type *New*

- ※ Draw-off Nut & Screw Thread type
- ※ Appropriate model for NC lathes
- ※ Coolant-proof models
- ※ Triple bearing method
- ※ Appropriate RPM(below 3800)

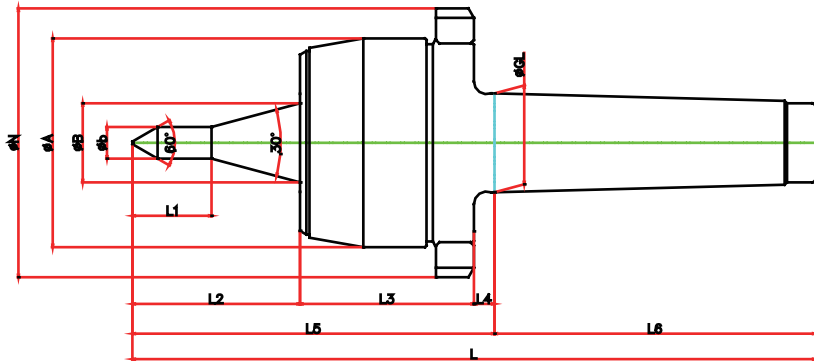

unit:mm/kg

Model	Morse Taper	Dimension											Weight Max. (lbs)	R.P.M Max.	Run out (inch)
		G	A	B	d	L1	L2	L3	L4	L5	L6	L			
<a href="#">LC-3NCNTH-06</a>	Mt.3	52	22	6	16.3	50	51	5	100	81	70	181	992.08	4,800	0.00011811
<a href="#">LC-3NCNTH-08</a>	Mt.3	52	22	8	20	50	51	5	100	81	70	181	992.08	4,800	0.00011811
<a href="#">LC-3NCNTH-10</a>	Mt.3	52	22	10	23.7	50	51	5	100	81	70	181	992.08	4,800	0.00011811
<a href="#">LC-3NCNTH-12</a>	Mt.3	52	22	12	27.5	50	51	5	100	81	70	181	992.08	4,800	0.00011811
<a href="#">LC-3NCNTH-14</a>	Mt.3	52	22	14	31.2	50	51	5	100	81	70	181	992.08	4,800	0.00011811
<a href="#">LC-3NCNTH-16</a>	Mt.3	52	22	16	34.9	50	51	5	100	81	70	181	992.08	4,800	0.00011811
<a href="#">LC-4NCNTH-06</a>	Mt.4	66	25	6	17.5	53	55	6.5	114.5	101.5	85	216	1719.61	3,800	0.00011811
<a href="#">LC-4NCNTH-08</a>	Mt.4	66	25	8	21.3	53	55	6.5	114.5	101.5	85	216	1719.61	3,800	0.00011811
<a href="#">LC-4NCNTH-10</a>	Mt.4	66	25	10	25	53	55	6.5	114.5	101.5	85	216	1719.61	3,800	0.00011811
<a href="#">LC-4NCNTH-12</a>	Mt.4	66	25	12	28.7	53	55	6.5	114.5	101.5	85	216	1719.61	3,800	0.00011811
<a href="#">LC-4NCNTH-14</a>	Mt.4	66	25	14	32.5	53	55	6.5	114.5	101.5	85	216	1719.61	3,800	0.00011811
<a href="#">LC-4NCNTH-16</a>	Mt.4	66	25	16	36.2	53	55	6.5	114.5	101.5	85	216	1719.61	3,800	0.00011811
<a href="#">LC-5NCNTH-06</a>	Mt.5	82	32	6	16.5	65	65	6.5	136.5	129.5	105	266	2425.09	3,400	0.00019685
<a href="#">LC-5NCNTH-08</a>	Mt.5	82	32	8	20.2	65	65	6.5	136.5	129.5	105	266	2425.09	3,400	0.00019685
<a href="#">LC-5NCNTH-10</a>	Mt.5	82	32	10	23.9	65	65	6.5	136.5	129.5	105	266	2425.09	3,400	0.00019685
<a href="#">LC-5NCNTH-12</a>	Mt.5	82	32	12	27.7	65	65	6.5	136.5	129.5	105	266	2425.09	3,400	0.00019685
<a href="#">LC-5NCNTH-14</a>	Mt.5	82	32	14	31.4	65	65	6.5	136.5	129.5	105	266	2425.09	3,400	0.00019685
<a href="#">LC-5NCNTH-16</a>	Mt.5	82	32	16	35.1	65	65	6.5	136.5	129.5	105	266	2425.09	3,400	0.00019685

※SPECIAL sizes or dimensions are available with quick turnaround

## NC-SPECIAL

※ Customized-special production for user's condition



# LC-NCP

## NCP-TYPE

- ▶ Live Center for CNC Lathes
- ▶ Sealed to prevent the inflow of cutting oils and foreign substances
- ▶ Upgraded bearings resulting in better durability and longer life compared to NC TYPE
- ▶ High precision of rotational accuracy and durability through using the triplexed bearing structure.
- ▶ Shaft heat treated to 58-62 HRc
- ▶ RUN OUT 0.00012" or 0.003mm



### NCPB TYPE

Minimize the bite-interference



### NCPBC TYPE

Minimize the bite-interference  
/ Carbide Type



### NCPBN TYPE

Minimize the bite-interference  
/ Nut Type



### NCPBCN TYPE

Minimize the bite-interference  
/ Carbide, Nut Type



### NCPC TYPE

Carbide Type



### NCPN TYPE

Nut Type



### NCPCN TYPE

Carbide, Nut Type



# NCP-TYPE

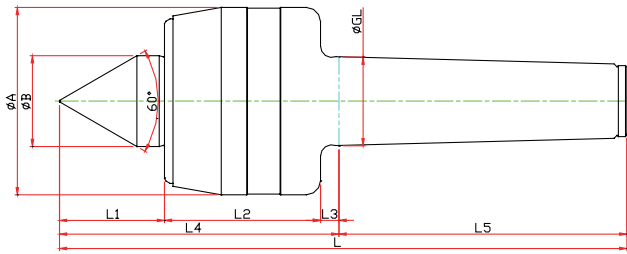

unit:mm/kg

Model	Morse Taper	Dimension										Weight Max. (lbs)	R.P.M Max.	Run out (inch)
		GL	A	B	L1	L2	L3	L4	L5	L				
<a href="#">LC-3NCP</a>	NO.3	23,825	50	22	27	45	5	77	81	158	1763.7	4800	0,00011811	
<a href="#">LC-4NCP</a>	NO.4	31,267	66	32	37	55	6,5	98,5	101,5	200	2866,01	3800	0,00011811	
<a href="#">LC-5NCP</a>	NO.5	44,399	82	40	45	65	6,5	116,5	129,5	246	4188,78	3400	0,00019685	
<a href="#">LC-6NCP</a>	NO.6	63,384	100	45	65	80	8	153	182	335	5511,56	3000	0,00019685	

※SPECIAL sizes or dimensions are available with quick turnaround

# NCPB-TYPE

※ SHAFT EXTENTION(Minimize the bite-interference)

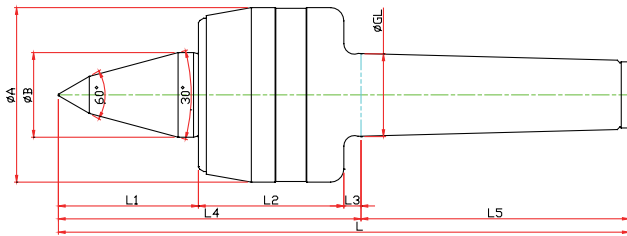

unit:mm/kg

Model	Morse Taper	Dimension										Weight Max. (lbs)	R.P.M Max.	Run out (inch)
		GL	A	B	b	L1	L2	L3	L4	L5	L			
<a href="#">LC-3NCPB</a>	NO.3	23,825	50	22	10	27	45	5	97	81	178	1763.7	4800	0,00011811
<a href="#">LC-4NCPB</a>	NO.4	31,267	66	32	14	37	55	6,5	114,5	101,5	216	2866,01	3800	0,00011811
<a href="#">LC-5NCPB</a>	NO.5	44,399	82	40	16	45	65	6,5	136,5	129,5	266	4188,78	3400	0,00019685
<a href="#">LC-6NCPB</a>	NO.6	63,384	100	45	18	65	80	8	166	182	348	5511,56	3000	0,00019685

※SPECIAL sizes or dimensions are available with quick turnaround

# NCPC-TYPE

※ Carbide Type

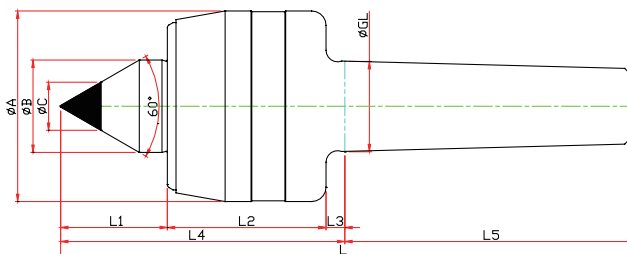

unit:mm/kg

Model	Morse Taper	Dimension										Weight Max. (lbs)	R.P.M Max.	Run out (inch)
		GL	A	B	L1	L2	L3	L4	L5	C	L			
<a href="#">LC-3NCPC</a>	NO.3	23,825	50	22	27	45	5	77	81	10	158	1763.7	4800	0,00011811
<a href="#">LC-4NCPC</a>	NO.4	31,267	66	32	37	55	6,5	98,5	101,5	14	200	2866,01	3800	0,00011811
<a href="#">LC-5NCPC</a>	NO.5	44,399	82	40	45	65	6,5	116,5	129,5	18	246	4188,78	3400	0,00019685
<a href="#">LC-6NCPC</a>	NO.6	63,384	100	45	65	80	8	153	182	25	335	5511,56	3000	0,00019685

※SPECIAL sizes or dimensions are available with quick turnaround

# NCPBC-TYPE

- ※ SHAFT EXTENTION(Minimize the bite-interference)
- ※ Carbide Type

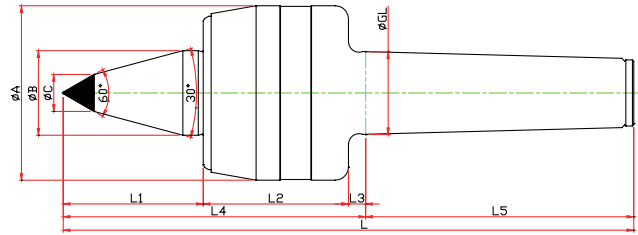

unit:mm/kg

Model	Morse Taper	Dimension										Weight Max. (lbs)	R.P.M Max.	Run out (inch)
		GL	A	B	L1	L2	L3	L4	L5	C	L			
<a href="#">LC-3NCPBC</a>	NO.3	23.825	50	22	27	45	5	97	81	10	178	1763.7	4800	0.00011811
<a href="#">LC-4NCPBC</a>	NO.4	31.267	66	32	37	55	6.5	114.5	101.5	14	216	2866.01	3800	0.00011811
<a href="#">LC-5NCPBC</a>	NO.5	44.399	82	40	45	65	6.5	136.5	129.5	16	266	4188.78	3400	0.00019685
<a href="#">LC-6NCPBC</a>	NO.6	63.384	100	45	65	80	8	166	182	18	348	5511.56	3000	0.00019685

※SPECIAL sizes or dimensions are available with quick turnaround

# NCPN-TYPE

- ※ Nut Type

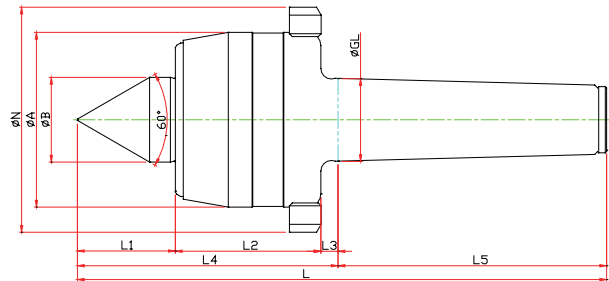

unit:mm/kg

Model	Morse Taper	Dimension										Weight Max. (lbs)	R.P.M Max.	Run out (inch)
		GL	A	B	L1	L2	L3	L4	L5	N	L			
<a href="#">LC-3NCPN</a>	NO.3	23.825	50	22	27	45	5	77	81	70	158	1763.7	4800	0.00011811
<a href="#">LC-4NCPN</a>	NO.4	31.267	66	32	37	55	6.5	98.5	101.5	85	200	2866.01	3800	0.00011811
<a href="#">LC-5NCPN</a>	NO.5	44.399	82	40	45	65	6.5	116.5	129.5	105	246	4188.78	3400	0.00019685
<a href="#">LC-6NCPN</a>	NO.6	63.384	100	45	65	80	8	153	182	130	335	5511.56	3000	0.00019685

※SPECIAL sizes or dimensions are available with quick turnaround

# NCPBN-TYPE

- ※ SHAFT EXTENTION(Minimize the bite-interference)
- ※ Nut Type

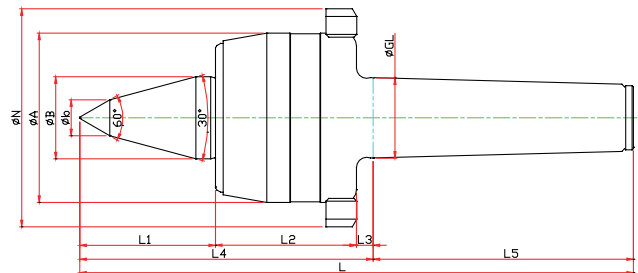

unit:mm/kg

Model	Morse Taper	Dimension											Weight Max. (lbs)	R.P.M Max.	Run out (inch)
		GL	A	B	b	L1	L2	L3	L4	L5	N	L			
<a href="#">LC-3NCPBN</a>	NO.3	23.825	50	22	10	47	45	5	97	81	70	178	1763.7	4800	0.00011811
<a href="#">LC-4NCPBN</a>	NO.4	31.267	66	32	14	53	55	6.5	114.5	101.5	85	216	2866.01	3800	0.00011811
<a href="#">LC-5NCPBN</a>	NO.5	44.399	82	40	16	65	65	6.5	136.5	129.5	105	266	4188.78	3400	0.00019685
<a href="#">LC-6NCPBN</a>	NO.6	63.384	100	45	18	78	80	8	166	182	130	348	5511.56	3000	0.00019685

※SPECIAL sizes or dimensions are available with quick turnaround



# NCPCN-TYPE

※ Carbide, Nut Type

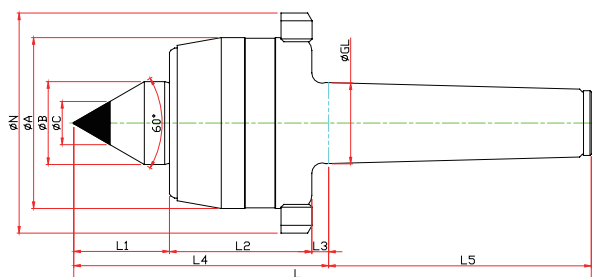

unit:mm/kg

Model	Morse Taper	Dimension											Weight Max. (lbs)	R.P.M Max.	Run out (inch)
		GL	A	B	L1	L2	L3	L4	L5	C	N	L			
<a href="#">LC-3NCPCN</a>	NO.3	23,825	50	22	27	45	5	77	81	10	70	158	1763.7	4800	0,00011811
<a href="#">LC-4NCPCN</a>	NO.4	31,267	66	32	37	55	6.5	98.5	101.5	14	85	200	2866.01	3800	0,00011811
<a href="#">LC-5NCPCN</a>	NO.5	44,399	82	40	45	65	6.5	116.5	129.5	18	105	246	4188.78	3400	0,00019685
<a href="#">LC-6NCPCN</a>	NO.6	63,384	100	45	65	80	8	153	182	25	130	335	5511.56	3000	0,00019685

※SPECIAL sizes or dimensions are available with quick turnaround

# NCPBCN-TYPE

※ SHAFT EXTENTION(Minimize the bite-interference)  
 ※ Carbide, Nut Type

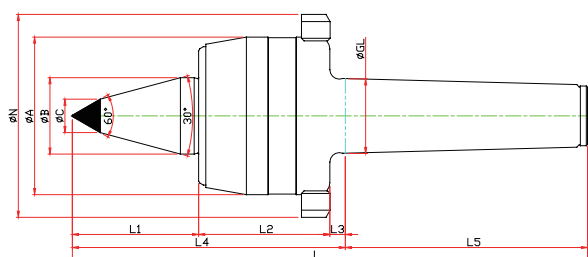

unit:mm/kg

Model	Morse Taper	Dimension											Weight Max. (lbs)	R.P.M Max.	Run out (inch)
		GL	A	B	L1	L2	L3	L4	L5	C	N	L			
<a href="#">LC-3NCPBCN</a>	NO.3	23,825	50	22	47	45	5	97	81	10	70	178	1763.7	4800	0,00011811
<a href="#">LC-4NCPBCN</a>	NO.4	31,267	66	32	53	55	6.5	114.5	101.5	14	85	216	2866.01	3800	0,00011811
<a href="#">LC-5NCPBCN</a>	NO.5	44,399	82	40	65	65	6.5	136.5	129.5	16	105	266	4188.78	3400	0,00019685
<a href="#">LC-6NCPBCN</a>	NO.6	63,384	100	45	78	80	8	166	182	25	130	348	5511.56	3000	0,00019685

※SPECIAL sizes or dimensions are available with quick turnaround

# NCP SPECIAL

※ Customized-special production for user's condition



# LC-NK

## NK · NKD-TYPE

- ▶ Centers for heavy duty and weight requirements
- ▶ Semi high-speed use
- ▶ Better durability and longer life due to using Taper Roller Bearings
- ▶ Shaft heat treated to 58-62 HRc
- ▶ RUN OUT 0.00012" or 0.003mm



### NKB TYPE

Minimize the bite-interference



### NKBC TYPE

Minimize the bite-interference  
/ Carbide Type



### NKBN TYP

Minimize the bite-interference



### NKBCN TYPE

Minimize the bite-interference  
/ Carbide, Nut Type



### NKC TYPE

Carbide Type



### NKN TYPE

Nut Type



### NKCN TYPE

Carbide, Nut Type



# NKB-TYPE

※ Center for heavy duty and Semi High Speed

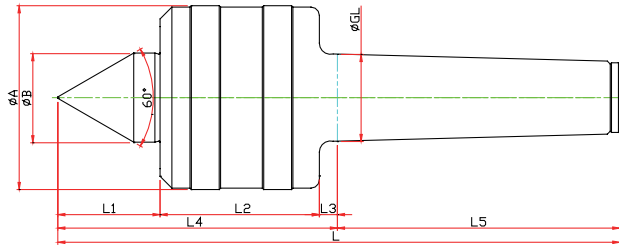

unit:mm/kg

Model	Morse Taper	Dimension										Weight Max. (lbs)	R.P.M Max.	Run out (inch)
		GL	A	B	L1	L2	L3	L4	L5	L				
<a href="#">LC-3NK</a>	NO.3	23,825	52	22	29	42	5	76	80	156	4188.78	5000	0,00011811	
<a href="#">LC-4NK</a>	NO.4	31,267	66	32	37	57	6.5	100.5	101.5	202	5952.48	3800	0,00011811	
<a href="#">LC-5NK</a>	NO.5	44,399	80	40	45.5	57	6.5	109	129.5	238.5	7054.79	3400	0,00019685	
<a href="#">LC-6NK</a>	NO.6	63,348	132	65	65	100	8	173	182	355	22046.23	1800	0,00019685	
<a href="#">LC-7NK</a>	NO.7	83,058	168	72	84	128	10	222	250	427	37919.52	1200	0,00019685	

※SPECIAL sizes or dimensions are available with quick turnaround

# NKB-TYPE

※ SHAFT EXTENTION(Minimize the bite-interference)

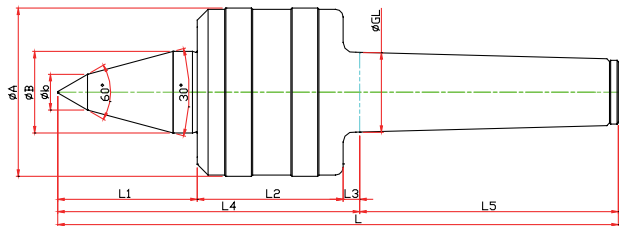

unit:mm/kg

Model	Morse Taper	Dimension										Weight Max. (lbs)	R.P.M Max.	Run out (inch)
		GL	A	B	b	L1	L2	L3	L4	L5	L			
<a href="#">LC-3NKB</a>	NO.3	23,825	52	22	10	48	42	5	95	80	175	4188.78	5000	0,00011811
<a href="#">LC-4NKB</a>	NO.4	31,267	66	32	14	53	57	6.5	116.5	101.5	218	5952.48	3800	0,00011811
<a href="#">LC-5NKB</a>	NO.5	44,399	80	40	18	65.5	57	6.5	129	129.5	258.5	7054.79	3400	0,00019685
<a href="#">LC-6NKB</a>	NO.6	63,348	132	65	25	78	100	8	186	182	368	22046.23	1800	0,00019685

※SPECIAL sizes or dimensions are available with quick turnaround

# NKC-TYPE

※ Carbide Type

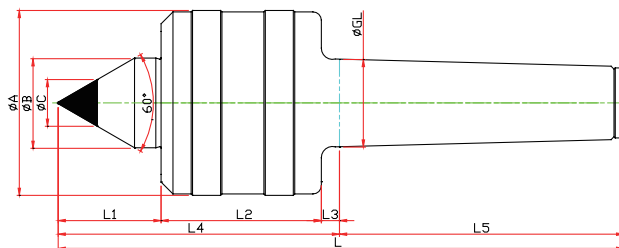

unit:mm/kg

Model	Morse Taper	Dimension										Weight Max. (lbs)	R.P.M Max.	Run out (inch)
		GL	A	B	L1	L2	L3	L4	L5	C	L			
<a href="#">LC-3NKC</a>	NO.3	23,825	52	22	29	42	5	76	80	10	156	4188.78	5000	0,00011811
<a href="#">LC-4NKC</a>	NO.4	31,267	66	32	37	57	6.5	100.5	101.5	14	202	5952.48	3800	0,00011811
<a href="#">LC-5NKC</a>	NO.5	44,399	80	40	45.5	57	6.5	109	129.5	18	238.5	7054.79	3400	0,00019685
<a href="#">LC-6NKC</a>	NO.6	63,348	132	65	65	100	8	173	182	25	355	22046.23	1800	0,00019685

※SPECIAL sizes or dimensions are available with quick turnaround

# NKBC-TYPE

- ※ SHAFT EXTENTION(Minimize the bite-interference)
- ※ Carbide Type

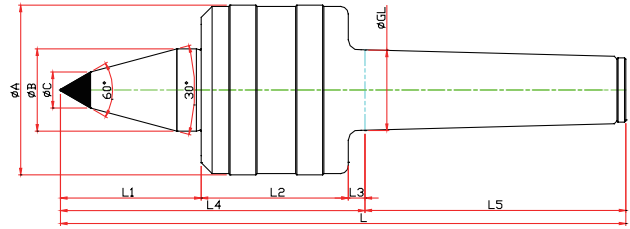

unit:mm/kg

Model	Morse Taper	Dimension										Weight Max. (lbs)	R.P.M Max.	Run out (inch)
		GL	A	B	L1	L2	L3	L4	L5	C	L			
<a href="#">LC-3NKBC</a>	NO.3	23.825	52	22	48	42	5	95	80	10	175	4188,78	5000	0,00011811
<a href="#">LC-4NKBC</a>	NO.4	31.267	66	32	53	57	6.5	116.5	101.5	14	218	5952,48	3800	0,00011811
<a href="#">LC-5NKBC</a>	NO.5	44.399	80	40	65,5	57	6.5	129	129,5	18	258,5	7054,79	3400	0,00019685
<a href="#">LC-6NKBC</a>	NO.6	63.348	132	65	78	100	8	186	182	25	368	22046,23	1800	0,00019685

※SPECIAL sizes or dimensions are available with quick turnaround

# NKN-TYPE

- ※ Nut Type

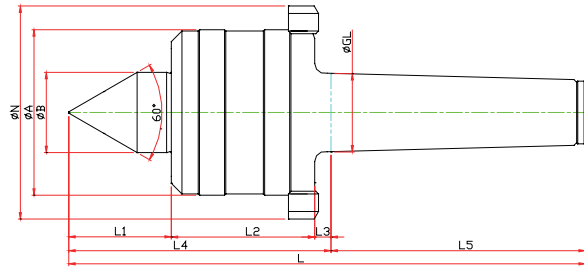

unit:mm/kg

Model	Morse Taper	Dimension										Weight Max. (lbs)	R.P.M Max.	Run out (inch)
		GL	A	B	L1	L2	L3	L4	L5	N	L			
<a href="#">LC-3NKN</a>	NO.3	23.825	52	22	29	42	5	76	80	70	156	4188,78	5000	0,00011811
<a href="#">LC-4NKN</a>	NO.4	31.267	66	32	37	57	6.5	100,5	101,5	85	202	5952,48	3800	0,00011811
<a href="#">LC-5NKN</a>	NO.5	44.399	80	40	45,5	57	6.5	109	129,5	98	238,5	7054,79	3400	0,00019685
<a href="#">LC-6NKN</a>	NO.6	63.348	132	65	65	100	8	173	182	165	355	22046,23	1800	0,00019685
<a href="#">LC-7NKN</a>	NO.7	83.058	168	72	84	128	10	222	250	210	427	37919,52	1200	0,00019685

※SPECIAL sizes or dimensions are available with quick turnaround

# NKBN-TYPE

- ※ SHAFT EXTENTION(Minimize the bite-interference)
- ※ Nut Type

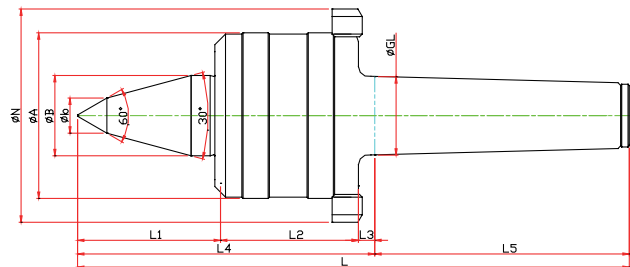

unit:mm/kg

Model	Morse Taper	Dimension											Weight Max. (lbs)	R.P.M Max.	Run out (inch)
		GL	A	B	b	L1	L2	L3	L4	L5	N	L			
<a href="#">LC-3NKBN</a>	NO.3	23.825	52	22	10	48	42	5	95	80	70	175	4188,78	5000	0,00011811
<a href="#">LC-4NKBN</a>	NO.4	31.267	66	32	14	53	57	6.5	116.5	101.5	85	218	5952,48	3800	0,00011811
<a href="#">LC-5NKBN</a>	NO.5	44.399	80	40	18	65,5	57	6.5	129	129,5	98	258,5	7054,79	3400	0,00019685
<a href="#">LC-6NKBN</a>	NO.6	63.348	132	65	25	78	100	8	186	182	165	368	22046,23	1800	0,00019685

※SPECIAL sizes or dimensions are available with quick turnaround

# NKCN-TYPE

※ Carbide, Nut Type

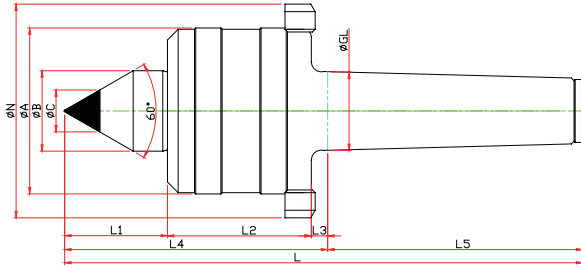

unit:mm/kg

Model	Morse Taper	Dimension											Weight Max. (lbs)	R.P.M Max.	Run out (inch)
		GL	A	B	L1	L2	L3	L4	L5	C	N	L			
<a href="#">LC-3NKCN</a>	NO.3	23,825	52	22	29	42	5	76	80	10	70	156	4188,78	5000	0,00011811
<a href="#">LC-4NKCN</a>	NO.4	31,267	66	32	37	57	6,5	100,5	101,5	14	85	202	5952,48	3800	0,00011811
<a href="#">LC-5NKCN</a>	NO.5	44,399	80	40	45,5	57	6,5	109	129,5	18	98	238,5	7054,79	3400	0,00019685
<a href="#">LC-6NKCN</a>	NO.6	63,348	132	65	65	100	8	173	182	25	165	355	22046,23	1800	0,00019685

※SPECIAL sizes or dimensions are available with quick turnaround

# NKBCN-TYPE

※ SHAFT EXTENTION(Minimize the bite-interference)

※ Carbide, Nut Type

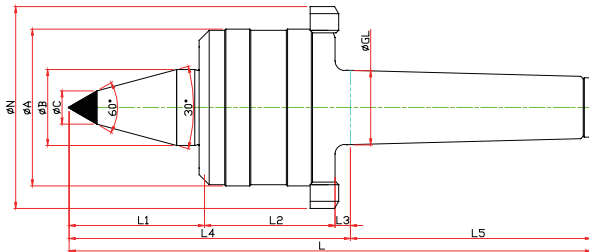

unit:mm/kg

Model	Morse Taper	Dimension											Weight Max. (lbs)	R.P.M Max.	Run out (inch)
		GL	A	B	L1	L2	L3	L4	L5	C	N	L			
<a href="#">LC-3NKBCN</a>	NO.3	23,825	52	22	48	42	5	95	80	10	70	175	4188,78	5000	0,00011811
<a href="#">LC-4NKBCN</a>	NO.4	31,267	66	32	53	57	6,5	116,5	101,5	14	85	218	5952,48	3800	0,00011811
<a href="#">LC-5NKBCN</a>	NO.5	44,399	80	40	65,5	57	6,5	129	129,5	18	98	258,5	7054,79	3400	0,00019685
<a href="#">LC-6NKBCN</a>	NO.6	63,348	132	65	78	100	8	186	182	25	165	368	22046,23	1800	0,00019685

※SPECIAL sizes or dimensions are available with quick turnaround

# LC-NKD

## NK · NKD-TYPE

- ▶ Live Center for heavy duty
- ▶ Semi High Speed
- ▶ Long life
- ▶ Use Taper Roller Bearing
- ▶ Hardness of SHAFT : HRC58~62



## NKD-TYPE

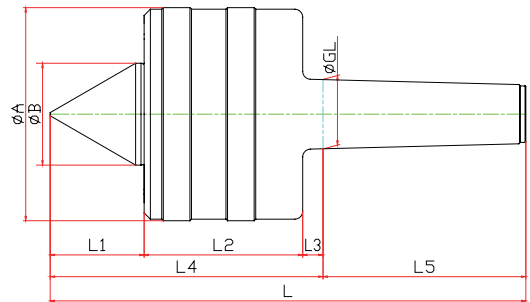

unit:mm/kg

Model	Morse Taper	Dimension									Weight Max. (lbs)	R.P.M Max.	Run out (inch)
		GL	A	B	L1	L2	L3	L4	L5	L			
<a href="#">LC-5NKD</a>	NO.5	44.399	136	65	60	101	13	174	129.5	303.5	28660.1	3400	0.00019685
<a href="#">LC-6NKD</a>	NO.6	63.348	148	70	80	110.5	15	205.5	181	387.5	35273.97	1800	0.00019685
<a href="#">LC-7NKD</a>	NO.7	83.058	200	95	90	141	20	251	250	501	48501.71	1200	0.00019685

※SPECIAL sizes or dimensions are available with quick turnaround



# LC-GR

## GR · SM-TYPE

- ▶ Live Centers for Grinding Applications
- ▶ High Precision Centers for heavy duty requirements
- ▶ RUN OUT 0.00008" or 0.002mm



## GR-TYPE

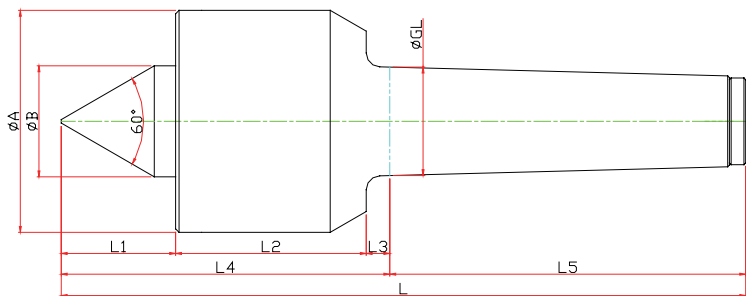

unit:mm/kg

Model	Morse Taper	Dimension									Weight Max. (lbs)	R.P.M Max.	Run out (inch)
		GL	A	B	L1	L2	L3	L4	L5	L			
<a href="#">LC-4GR</a>	NO.4	31.267	71	40	45	59.5	6.5	111	101.5	212.5	2866.01	7000	0.00007874
<a href="#">LC-5GR</a>	NO.5	44.399	88	50	45	66	6.5	117.5	129.5	247	7716.18	4500	0.00007874
<a href="#">LC-6GR</a>	NO.6	63.348	114	52	55	92	8	155	182	337	11023.12	3400	0.00007874
<a href="#">LC-7GR</a>	NO.7	83.058	200	98	78	132	10	200	250	470	44092.46	1900	0.00007874

※SPECIAL sizes or dimensions are available with quick turnaround

# LC-SM

## GR · SM-TYPE

- ▶ Live Centers with special bearings for high-speed rotation
- ▶ Shaft heat treated to 58-62 HRc
- ▶ RUN OUT 0.00012" or 0.003mm



### SMB TYPE

Minimize the bite-interference



### SMBC TYPE

Minimize the bite-interference  
/ Carbide Type



### SMBN TYPE

Minimize the bite-interference  
/ Nut Type



### SMBCN TYPE

Minimize the bite-interference  
/ Carbide, Nut Type



### SMC TYPE

Carbide Type



### SMN TYPE

Nut Type



### SMCN TYPE

Carbide, Nut Type



# SM-TYPE

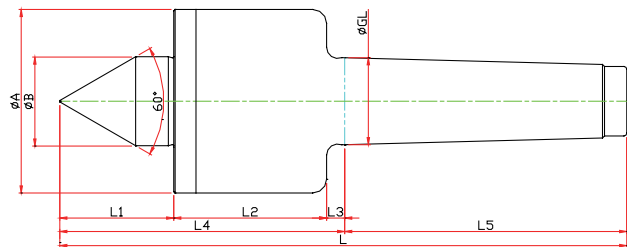

unit:mm/kg

Model	Morse Taper	Dimension									Weight Max. (lbs)	R.P.M Max.	Run out (inch)
		GL	A	B	L1	L2	L3	L4	L5	L			
<a href="#">LC-3SM</a>	NO.3	23,825	52	22	30	51	5	86	81	167	727.53	12000	0,00011811
<a href="#">LC-4SM</a>	NO.4	31,267	66	32	41	55	6.5	102.5	101.5	204	2425.09	10000	0,00011811
<a href="#">LC-5SM</a>	NO.5	44,399	82	40	51	75	6.5	132.5	129.5	262	4850.17	8000	0,00019685

※SPECIAL sizes or dimensions are available with quick turnaround

# SMB-TYPE

※ SHAFT EXTENTION(Minimize the bite-interference)

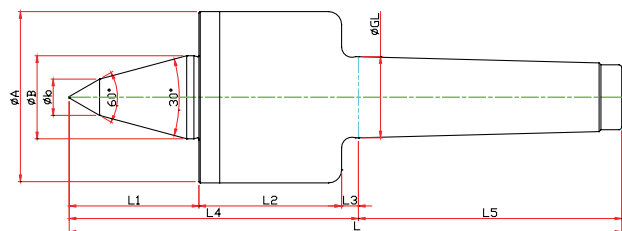

unit:mm/kg

Model	Morse Taper	Dimension										Weight Max. (lbs)	R.P.M Max.	Run out (inch)
		GL	A	B	b	L1	L2	L3	L4	L5	L			
<a href="#">LC-3SMB</a>	NO.3	23,825	52	22	10	40	51	5	96	81	177	727.53	12000	0,00011811
<a href="#">LC-4SMB</a>	NO.4	31,267	66	32	14	50	55	6.5	111.5	101.5	213	2425.09	10000	0,00011811
<a href="#">LC-5SMB</a>	NO.5	44,399	82	40	16	65	75	6.5	146.5	129.5	276	4850.17	8000	0,00019685

※SPECIAL sizes or dimensions are available with quick turnaround

# SMC-TYPE

※ Carbide Type

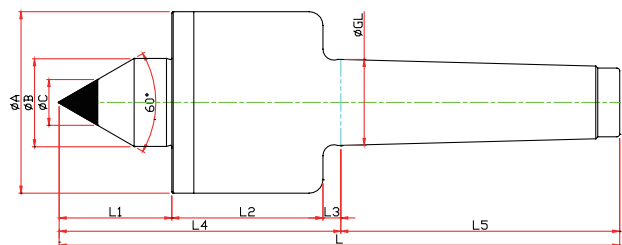

unit:mm/kg

Model	Morse Taper	Dimension										Weight Max. (lbs)	R.P.M Max.	Run out (inch)
		GL	A	B	L1	L2	L3	L4	L5	C	L			
<a href="#">LC-3SMC</a>	NO.3	23,825	52	22	30	51	5	86	81	10	167	727.53	12000	0,00011811
<a href="#">LC-4SMC</a>	NO.4	31,267	66	32	41	55	6.5	102.5	101.5	14	204	2425.09	10000	0,00011811
<a href="#">LC-5SMC</a>	NO.5	44,399	82	40	51	75	6.5	132.5	129.5	18	262	4850.17	8000	0,00019685

※SPECIAL sizes or dimensions are available with quick turnaround

# SMBC-TYPE

- ※ SHAFT EXTENTION(Minimize the bite-interference)
- ※ Carbide Type

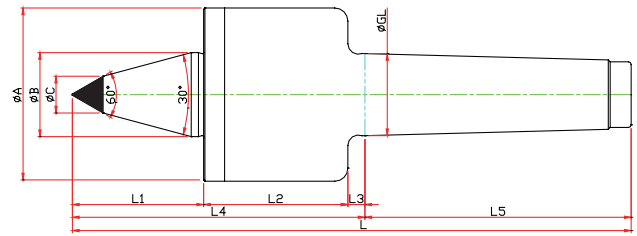

unit:mm/kg

Model	Morse Taper	Dimension											Weight Max. (lbs)	R.P.M Max.	Run out (inch)
		GL	A	B	b	L1	L2	L3	L4	L5	C	L			
<a href="#">LC-3SMBC</a>	NO.3	23.825	52	22	10	40	51	5	96	81	10	177	727.53	12000	0,00011811
<a href="#">LC-4SMBC</a>	NO.4	31.267	66	32	14	50	55	6.5	111.5	101.5	14	213	2425.09	10000	0,00011811
<a href="#">LC-5SMBC</a>	NO.5	44.399	82	40	16	65	75	6.5	146.55	129.5	16	276	4850.17	8000	0,00019685

※SPECIAL sizes or dimensions are available with quick turnaround

# SMN-TYPE

- ※ Nut Type

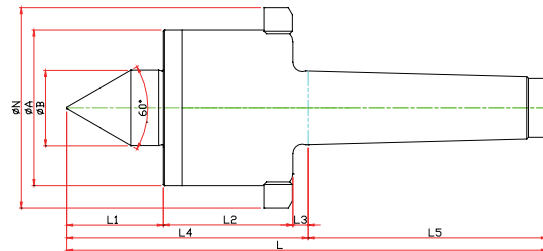

unit:mm/kg

Model	Morse Taper	Dimension										Weight Max. (lbs)	R.P.M Max.	Run out (inch)
		GL	A	B	L1	L2	L3	L4	L5	N	L			
<a href="#">LC-3SMN</a>	NO.3	23.825	52	22	30	51	5	86	81	70	167	727.53	12000	0,00011811
<a href="#">LC-4SMN</a>	NO.4	31.267	66	32	41	55	6.5	102.5	101.5	85	204	2425.09	10000	0,00011811
<a href="#">LC-5SMN</a>	NO.5	44.399	82	40	51	75	6.5	132.5	129.5	105	262	4850.17	8000	0,00019685

※SPECIAL sizes or dimensions are available with quick turnaround

# SMBN-TYPE

- ※ SHAFT EXTENTION(Minimize the bite-interference)
- ※ Nut Type

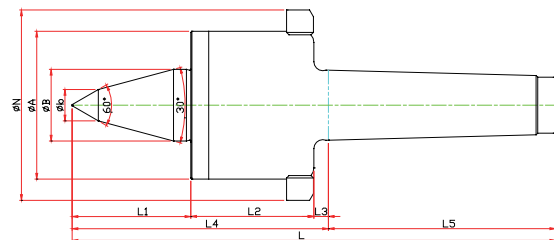

unit:mm/kg

Model	Morse Taper	Dimension											Weight Max. (lbs)	R.P.M Max.	Run out (inch)
		GL	A	B	b	L1	L2	L3	L4	L5	N	L			
<a href="#">LC-3SMBN</a>	NO.3	23.825	52	22	10	40	51	5	96	81	70	177	727.53	12000	0,00011811
<a href="#">LC-4SMBN</a>	NO.4	31.267	66	32	14	50	55	6.5	111.5	101.5	85	213	2425.09	10000	0,00011811
<a href="#">LC-5SMBN</a>	NO.5	44.399	82	40	16	65	75	6.5	146.5	129.5	105	276	4850.17	8000	0,00019685

※SPECIAL sizes or dimensions are available with quick turnaround

# SMCN-TYPE

※ Carbide, Nut Type

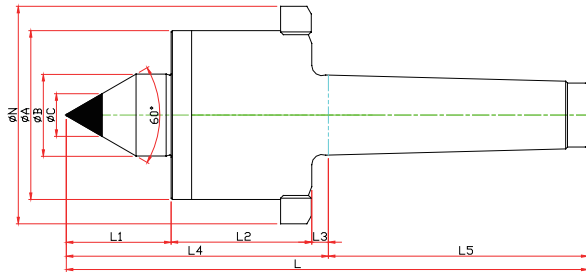

unit:mm/kg

Model	Morse Taper	Dimension											Weight Max. (lbs)	R.P.M Max.	Run out (inch)
		GL	A	B	C	D	E	F	G	N	T	L			
<a href="#">LC-3SMCN</a>	NO.3	23,825	52	22	30	51	5	86	81	70	10	167	661.39	12000	0,00011811
<a href="#">LC-4SMCN</a>	NO.4	31,267	66	32	41	55	6.5	102.5	101.5	85	14	204	2425.09	10000	0,00011811
<a href="#">LC-5SMCN</a>	NO.5	44,399	82	40	51	75	6.5	132.5	129.5	105	16	262	4850.17	8000	0,00019685

※SPECIAL sizes or dimensions are available with quick turnaround

# SMBCN-TYPE

※ SHAFT EXTENTION(Minimize the bite-interference)  
 ※ Carbide, Nut Type

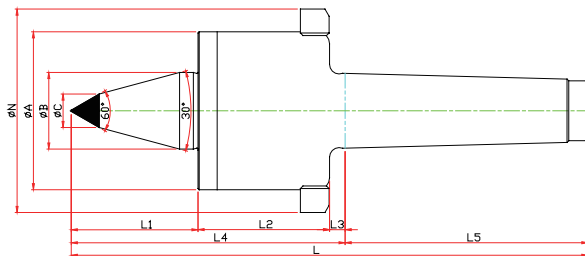

unit:mm/kg

Model	Morse Taper	Dimension											Weight Max. (lbs)	R.P.M Max.	Run out (inch)	
		GL	A	B	b	L1	L2	L3	L4	L5	C	N				L
<a href="#">LC-3SMBCN</a>	NO.3	23,825	52	22	10	40	51	5	96	81	10	70	177	727.53	12000	0,00011811
<a href="#">LC-4SMBCN</a>	NO.4	31,267	66	32	14	50	55	6.5	111.5	101.5	14	85	213	2425.09	10000	0,00011811
<a href="#">LC-5SMBCN</a>	NO.5	44,399	82	40	16	65	75	6.5	146.5	129.5	16	105	276	4850.17	8000	0,00019685

※SPECIAL sizes or dimensions are available with quick turnaround

# LC-SMP

## SMP-TYPE

- ▶ Live Center with high-speed bearings for high-speed rotation
- ▶ Upgraded bearings resulting in better durability and longer life compared to SM TYPE
- ▶ Shaft heat treated to 58-62 HRc
- ▶ RUN OUT 0.00012" or 0.003mm



### SMPB TYPE

Minimize the bite-interference



### SMPBC TYPE

Minimize the bite-interference  
/ Carbide Type



### SMPBN TYPE

Minimize the bite-interference  
/ Nut Type



### SMPBCN TYPE

Minimize the bite-interference  
/ Carbide, Nut Type



### SMPC TYPE

Carbide Type



### SMPN TYPE

Nut Type



### SMPCN TYPE

Carbide, Nut Type





# SMP-TYPE

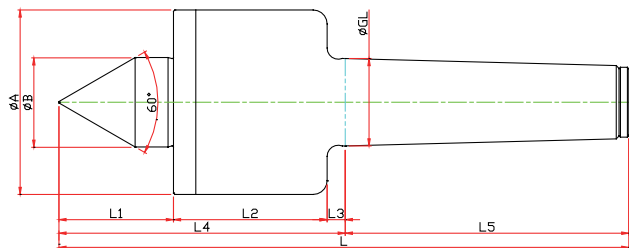

unit:mm/kg

Model	Morse Taper	Dimension									Weight Max. (lbs)	R.P.M Max.	Run out (inch)
		GL	A	B	L1	L2	L3	L4	L5	L			
<a href="#">LC-3SMP</a>	NO.3	23,825	52	22	30	51	5	86	81	167	727.53	12000	0,00011811
<a href="#">LC-4SMP</a>	NO.4	31,267	66	32	41	55	6.5	102.5	101.5	204	2425.09	10000	0,00011811
<a href="#">LC-5SMP</a>	NO.5	44,399	82	40	51	75	6.5	132.5	129.5	262	4850.17	8000	0,00019685

※SPECIAL sizes or dimensions are available with quick turnaround

# SMPB-TYPE

※ SHAFT EXTENSION(Minimize the bite-interference)

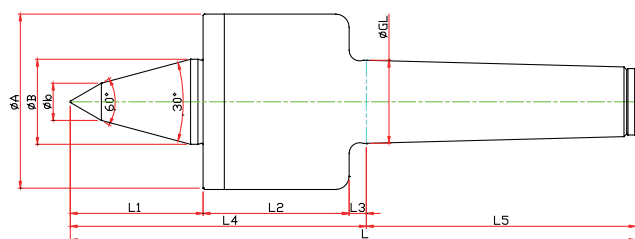

unit:mm/kg

Model	Morse Taper	Dimension										Weight Max. (lbs)	R.P.M Max.	Run out (inch)
		GL	A	B	b	L1	L2	L3	L4	L5	L			
<a href="#">LC-3SMPB</a>	NO.3	23,825	52	22	10	40	51	5	96	81	177	727.53	12000	0,00011811
<a href="#">LC-4SMPB</a>	NO.4	31,267	66	32	14	50	55	6.5	111.5	101.5	213	2425.09	10000	0,00011811
<a href="#">LC-5SMPB</a>	NO.5	44,399	82	40	16	65	75	6.5	146.5	129.5	276	4850.17	8000	0,00019685

※SPECIAL sizes or dimensions are available with quick turnaround

# SMPC-TYPE

※ Carbide Type

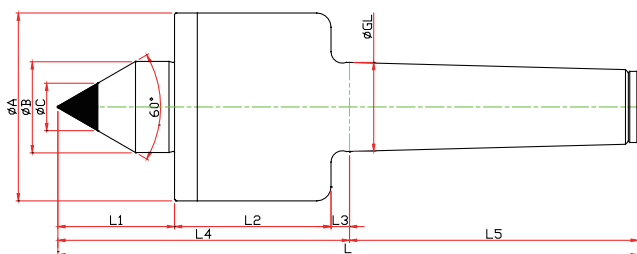

unit:mm/kg

Model	Morse Taper	Dimension										Weight Max. (lbs)	R.P.M Max.	Run out (inch)
		GL	A	B	L1	L2	L3	L4	L5	C	L			
<a href="#">LC-3SMPC</a>	NO.3	23,825	52	22	30	51	5	86	81	10	167	727.53	12000	0,00011811
<a href="#">LC-4SMPC</a>	NO.4	31,267	66	32	41	55	6.5	102.5	101.5	14	204	2425.09	10000	0,00011811
<a href="#">LC-5SMPC</a>	NO.5	44,399	82	40	51	75	6.5	132.5	129.5	18	262	4850.17	8000	0,00019685

※SPECIAL sizes or dimensions are available with quick turnaround

# SMPBC-TYPE

- ※ SHAFT EXTENTION(Minimize the bite-interference)
- ※ Carbide Type

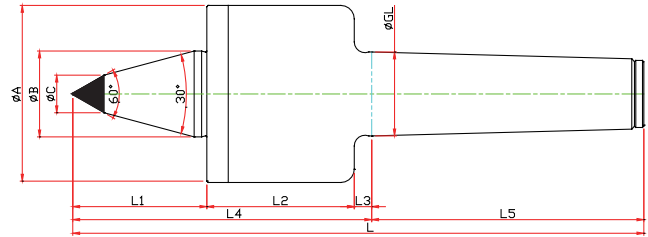

unit:mm/kg

Model	Morse Taper	Dimension											Weight Max. (lbs)	R.P.M Max.	Run out (inch)
		GL	A	B	b	L1	L2	L3	L4	L5	C	L			
<a href="#">LC-3SMPBC</a>	NO.3	23.825	52	22	10	40	51	5	96	81	10	177	727.53	12000	0,00011811
<a href="#">LC-4SMPBC</a>	NO.4	31.267	66	32	14	50	55	6.5	111.5	101.5	14	213	2425.09	10000	0,00011811
<a href="#">LC-5SMPBC</a>	NO.5	44.399	82	40	16	65	75	6.5	146.5	129.5	18	276	4850.17	8000	0,00019685

※SPECIAL sizes or dimensions are available with quick turnaround

# SMPN-TYPE

- ※ Nut Type

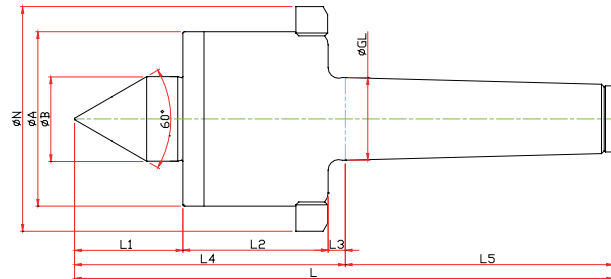

unit:mm/kg

Model	Morse Taper	Dimension											Weight Max. (lbs)	R.P.M Max.	Run out (inch)
		GL	A	B	L1	L2	L3	L4	L5	N	L				
<a href="#">LC-3SMPN</a>	NO.3	23.825	52	22	30	51	5	86	81	70	167	727.53	12000	0,00011811	
<a href="#">LC-4SMPN</a>	NO.4	31.267	66	32	41	55	6.5	102.5	101.5	85	204	2425.09	10000	0,00011811	
<a href="#">LC-5SMPN</a>	NO.5	44.399	82	40	51	75	6.5	132.5	129.5	105	262	4850.17	8000	0,00019685	

※SPECIAL sizes or dimensions are available with quick turnaround

# SMPBN-TYPE

- ※ SHAFT EXTENTION(Minimize the bite-interference)
- ※ Nut Type

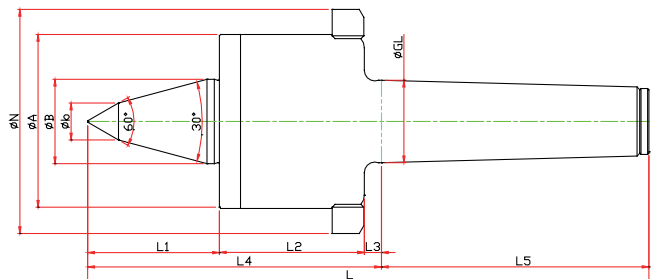

unit:mm/kg

Model	Morse Taper	Dimension											Weight Max. (lbs)	R.P.M Max.	Run out (inch)
		GL	A	B	b	L1	L2	L3	L4	L5	N	L			
<a href="#">LC-3SMPBN</a>	NO.3	23.825	52	22	10	40	51	5	96	81	70	177	727.53	12000	0,00011811
<a href="#">LC-4SMPBN</a>	NO.4	31.267	66	32	14	50	55	6.5	111.5	101.5	85	213	2425.09	10000	0,00011811
<a href="#">LC-5SMPBN</a>	NO.5	44.399	82	40	16	65	75	6.5	146.5	129.5	105	276	4850.17	8000	0,00019685

※SPECIAL sizes or dimensions are available with quick turnaround

# SMPCN-TYPE

※ Nut, Carbide Type

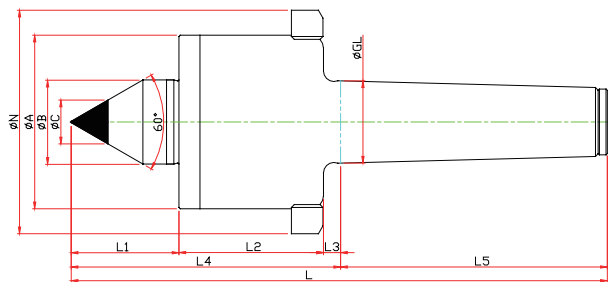

unit:mm/kg

Model	Morse Taper	Dimension											Weight Max. (lbs)	R.P.M Max.	Run out (inch)
		GL	A	B	L1	L2	L3	L4	L5	C	N	L			
<a href="#">LC-3SMPCN</a>	NO.3	23,825	52	22	30	51	5	86	81	10	70	167	727.53	12000	0,00011811
<a href="#">LC-4SMPCN</a>	NO.4	31,267	66	32	41	55	6.5	102.5	101.5	14	85	204	2425.09	10000	0,00011811
<a href="#">LC-5SMPCN</a>	NO.5	44,399	82	40	51	75	6.5	132.5	129.5	18	105	262	4850.17	8000	0,00019685

※SPECIAL sizes or dimensions are available with quick turnaround

# SMPBCN-TYPE

※ SHAFT EXTENTION(Minimize the bite-interference)  
 ※ Nut, Carbide Type

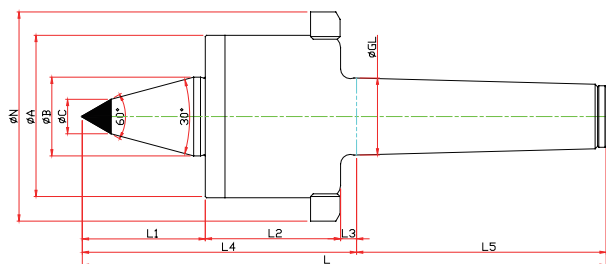

unit:mm/kg

Model	Morse Taper	Dimension												Weight Max. (lbs)	R.P.M Max.	Run out (inch)
		GL	A	B	b	L1	L2	L3	L4	L5	C	N	L			
<a href="#">LC-3SMPBCN</a>	NO.3	23,825	52	22	10	40	51	5	96	81	10	70	177	727.53	12000	0,00011811
<a href="#">LC-4SMPBCN</a>	NO.4	31,267	66	32	14	50	55	6.5	111.5	101.5	14	85	213	2425.09	10000	0,00011811
<a href="#">LC-5SMPBCN</a>	NO.5	44,399	82	40	16	65	75	6.5	146.5	129.5	16	105	276	4850.17	8000	0,00019685

※SPECIAL sizes or dimensions are available with quick turnaround

# SMP SPECIAL

※ Customized-special production for user's condition



# D50-TYPE

- ▶ Live Center for CNC Lathes
- ▶ Minimum bite-interference
- ▶ Sealed to prevent the inflow of cutting oils and foreign substances
- ▶ RUN OUT 0.00012"/0.0002" or 0.003mm/0.005mm



## D50B TYPE

Minimize the bite-interference



## D50C TYPE

Carbide Type



## D50BC TYPE

Minimize the bite-interference  
/ Carbide Type



# D50-TYPE

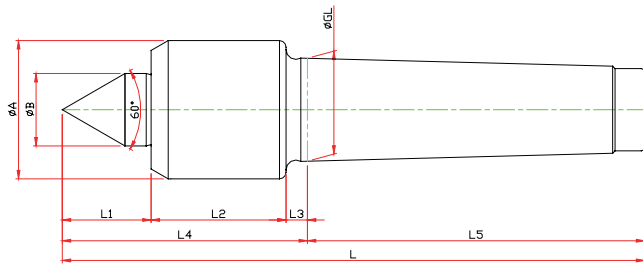

unit:mm/kg

Model	Morse Taper	Dimension									Weight Max. (lbs)	R.P.M Max.	Run out (inch)
		GL	A	B	L1	L2	L3	L4	L5	L			
<a href="#">LC-3D50</a>	NO.3	23,825	34	22	21	38	5	64	81	145	881.85	4800	0,00011811
<a href="#">LC-4D50</a>	NO.4	31,267	42	22	27	41	6.5	74.5	102.5	177	1763.7	3800	0,00011811
<a href="#">LC-5D50</a>	NO.5	44,399	58	32	35	60	6.5	101.5	129.5	231	3527.4	3400	0,00019685

※SPECIAL sizes or dimensions are available with quick turnaround

# D50B-TYPE

※ SHAFT EXTENSION(Minimize the bite-interference)

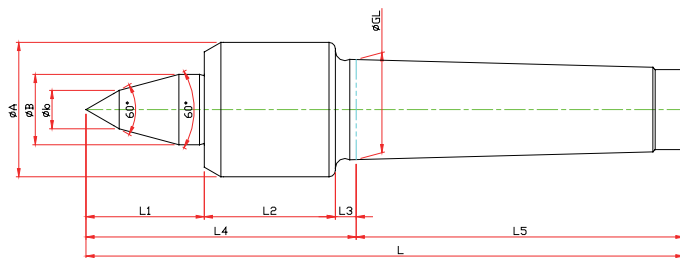

unit:mm/kg

Model	Morse Taper	Dimension										Weight Max. (lbs)	R.P.M Max.	Run out (inch)
		GL	A	B	b	L1	L2	L3	L4	L5	L			
<a href="#">LC-3D50B</a>	NO.3	23,825	34	22	10	25	38	5	72	81	153	881.85	4800	0,00011811
<a href="#">LC-4D50B</a>	NO.4	31,267	42	22	12	36	41	6.5	83.5	102.5	186.5	1763.7	3800	0,00011811
<a href="#">LC-5D50B</a>	NO.5	44,399	58	32	16	53	60	6.5	119.5	129.5	249	3527.4	3400	0,00019685

※SPECIAL sizes or dimensions are available with quick turnaround

# D50C-TYPE

※ Carbide Type

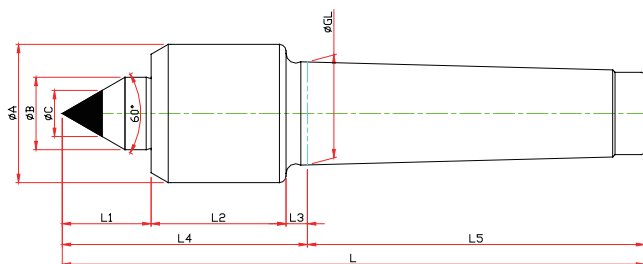

unit:mm/kg

Model	Morse Taper	Dimension										Weight Max. (lbs)	R.P.M Max.	Run out (inch)
		GL	A	B	L1	L2	L3	L4	L5	C	L			
<a href="#">LC-3D50C</a>	NO.3	23,825	34	22	21	38	5	64	81	10	145	881.85	4800	0,00011811
<a href="#">LC-4D50C</a>	NO.4	31,267	42	22	27	41	6.5	74.5	102.5	14	177	1763.7	3800	0,00011811
<a href="#">LC-5D50C</a>	NO.5	44,399	58	32	60	60	6.5	101.5	129.5	18	231	3527.4	3400	0,00019685

※SPECIAL sizes or dimensions are available with quick turnaround

# D50BC-TYPE

- ※ SHAFT EXTENTION(Minimize the bite-interference)
- ※ Carbide Type

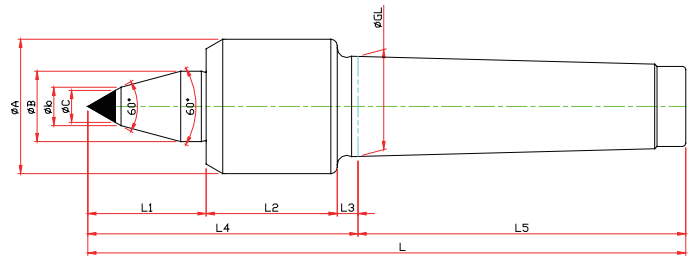

unit:mm/kg

Model	Morse Taper	Dimension											Weight Max. (lbs)	R.P.M Max.	Run out (inch)
		GL	A	B	b	L1	L2	L3	L4	L5	C	L			
<a href="#">LC-3D50BC</a>	NO.3	23.825	34	22	10	25	38	5	72	81	8	153	881.85	4800	0,00011811
<a href="#">LC-4D50BC</a>	NO.4	31.267	42	22	12	36	41	6.5	83.5	102.5	10	186.5	1763.7	3800	0,00011811
<a href="#">LC-5D50BC</a>	NO.5	44.399	58	32	16	53	60	6.5	119.5	129.5	14	249	3527.4	3400	0,00019685

※SPECIAL sizes or dimensions are available with quick turnaround

# D50 SPECIAL

- ※ Customized-special production for user's condition



# HD-TYPE

- ▶ Economical Live Centers
- ▶ Has wide range of uses and applications
- ▶ CAP Rotation Type which prevents the inflow of foreign substances
- ▶ RUN OUT 0.00012"/0.00024" or 0.003mm/0.006mm



## HDC TYPE

Carbide Type



## HDS TYPE

Minimized Body for less bite interference



## HDSC TYPE

Minimized Body for less bite interference / Carbide Type



## HDSTH TYPE

Minimize the bite-interference





# HD-TYPE

※ Economical live center

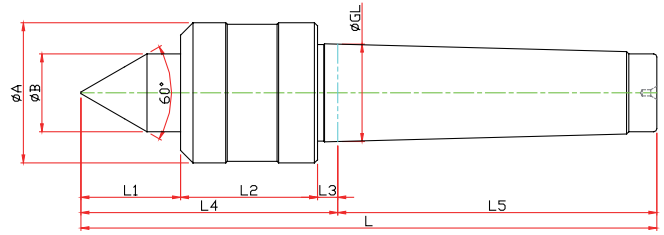

unit:mm/kg

Model	Morse Taper	Dimension									Weight Max. (lbs)	R.P.M Max.	Run out (inch)
		GL	A	B	L1	L2	L3	L4	L5	L			
<a href="#">LC-1HD</a>	NO.1	12,065	34	15	21	37	3,5	61,5	53,5	115	264,55	5000	0,00011811
<a href="#">LC-2HD</a>	NO.2	17,780	40	18	24	37	5	66	64	130	308,65	4000	0,00011811
<a href="#">LC-3HD</a>	NO.3	23,825	45	25	32	44	5	81	81	162	418,88	3800	0,00011811
<a href="#">LC-4HD</a>	NO.4	31,267	45	25	32	44	6,5	82,5	102,5	185	418,88	3800	0,00011811
<a href="#">LC-5HD</a>	NO.5	44,399	78	38	47	66	6,5	119,5	129,5	249	771,62	2000	0,00019685
<a href="#">LC-6HD</a>	NO.6	63,384	102	55	62	82	8	152	182	334	2645,55	2000	0,00019685

※SPECIAL sizes or dimensions are available with quick turnaround

# HDC-TYPE

※ Carbide Type

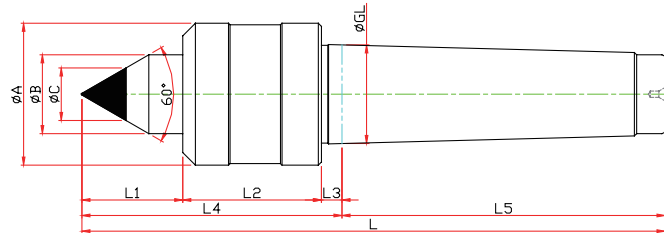

unit:mm/kg

Model	Morse Taper	Dimension										Weight Max. (lbs)	R.P.M Max.	Run out (inch)
		GL	A	B	L1	L2	L3	L4	L5	C	L			
<a href="#">LC-3HDC</a>	NO.3	23,825	25	45	32	44	5	81	81	10	162	418,88	3800	0,00011811
<a href="#">LC-4HDC</a>	NO.4	31,267	25	45	32	44	6,5	82,5	102,5	14	185	418,88	3800	0,00011811
<a href="#">LC-5HDC</a>	NO.5	44,399	38	78	47	66	6,5	119,5	129,5	18	249	771,62	2000	0,00019685
<a href="#">LC-6HDC</a>	NO.6	63,384	55	102	62	82	8	152	182	25	334	2645,55	2000	0,00019685

※SPECIAL sizes or dimensions are available with quick turnaround

# HDS-TYPE

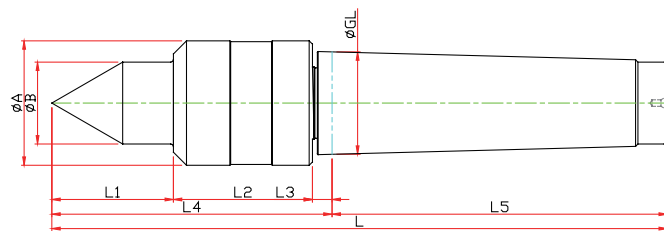

unit:mm/kg

Model	Morse Taper	Dimension									Weight Max. (lbs)	R.P.M Max.	Run out (inch)
		GL	A	B	L1	L2	L3	L4	L5	L			
<a href="#">LC-2HDS</a>	NO.2	17,780	34	15	25	40	5	70	64	134	154,32	4500	0,00011811
<a href="#">LC-3HDS</a>	NO.3	23,825	36	18	27,5	40,5	5	73	81	154	176,37	4500	0,00011811
<a href="#">LC-4HDS</a>	NO.4	31,267	38	22	32	42,5	6	80,5	102,5	183	176,37	4500	0,00011811
<a href="#">LC-5HDS</a>	NO.5	44,399	64	30	47	56,5	10	113,5	129,5	243	507,06	2000	0,00019685
<a href="#">LC-6HDS</a>	NO.6	63,384	86	42	60	66,5	10	136,5	182	318,5	1322,77	1500	0,00019685

※SPECIAL sizes or dimensions are available with quick turnaround

# HDSC-TYPE

- ※ Economical live center
- ※ Suitable for lathe
- ※ Optimal RPM(below 3,800)

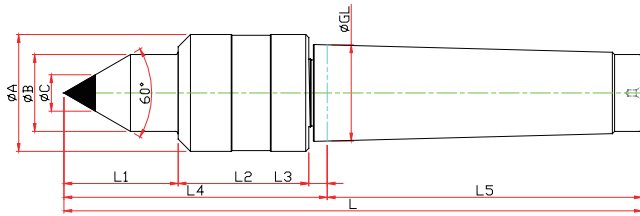

unit:mm/kg

Model	Morse Taper	Dimension										Weight Max. (lbs)	R.P.M Max.	Run out (inch)
		GL	A	B	L1	L2	L3	L4	L5	C	L			
<a href="#">LC-3HDSC</a>	NO.3	23,825	36	18	27,5	40,5	5	73	81	10	154	176,37	4500	0,00011811
<a href="#">LC-4HDSC</a>	NO.4	31,267	38	22	32	42,5	6	80,5	102,5	14	183	176,37	4500	0,00011811
<a href="#">LC-5HDSC</a>	NO.5	44,399	64	30	47	56,5	10	113,5	129,5	18	243	507,06	2000	0,00019685
<a href="#">LC-6HDSC</a>	NO.6	63,384	86	42	60	66,5	10	136,5	182	30	318,5	1322,77	1500	0,00019685

※SPECIAL sizes or dimensions are available with quick turnaround

# HDSTH-TYPE

- ※ The type of thread milling
- ※ The resistant structure for cutting oil
- ※ Fit triple bearings
- ※ Optimal RPM(below 3,800)

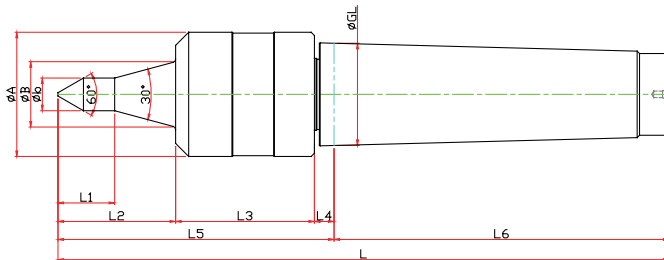

unit:mm/kg

Model	Morse Taper	Dimension											Weight Max. (lbs)	R.P.M Max.	Run out (inch)
		GL	A	B	b	L1	L2	L3	L4	L5	L6	L			
<a href="#">LC-3HDSTH-06</a>	NO.3	23,825	36	18	6	12,6	35	40,5	5	80,5	81	161,5	121,25	3800	0,00011811
<a href="#">LC-3HDSTH-08</a>					8	16,3									
<a href="#">LC-3HDSTH-10</a>					10	20,1									
<a href="#">LC-3HDSTH-12</a>					12	23,8									
<a href="#">LC-4HDSTH-06</a>	NO.4	31,267	38	20	6	10,1	36,2	40,5	6	84,5	102,5	187	143,3	3800	0,00011811
<a href="#">LC-4HDSTH-08</a>					8	13,9									
<a href="#">LC-4HDSTH-10</a>					10	17,6									
<a href="#">LC-4HDSTH-12</a>					12	21,3									
<a href="#">LC-5HDSTH-06</a>	NO.5	44,399	64	24	6	13,4	47	56,5	10	113,5	129,5	243	330,69	3800	0,00011811
<a href="#">LC-5HDSTH-08</a>					8	17,1									
<a href="#">LC-5HDSTH-10</a>					10	20,8									
<a href="#">LC-4HDSTH-12</a>					12	24,6									

※SPECIAL sizes or dimensions are available with quick turnaround

# HD SPECIAL



# PT-TYPE

- ▶ For PIPE machining
- ▶ Optimal RPM (below 3800)
- ▶ RUN OUT 0.00012"/0.0002" or 0.003mm/0.005mm



## PT-60 TYPE

For PIPE machining  
Optimal RPM(below 3,800)



## PT-80 TYPE

For PIPE machining  
Optimal RPM(below 3,800)



# PT-60 TYPE

※ For PIPE machining  
 ※ Optimal RPM(below 3,800)

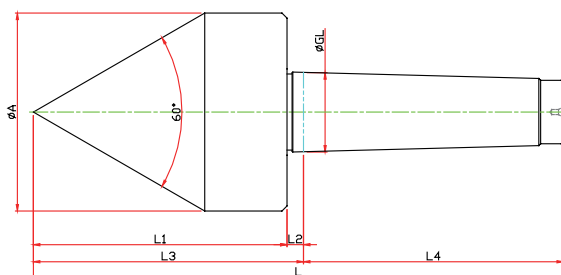

unit:mm/kg

Model	Morse Taper	Dimension							Weight Max. (lbs)	R.P.M Max.	Run out (inch)
		GL	A	L1	L2	L3	L4	L			
<a href="#">LC-2PT-60</a>	NO.2	17.780	44	66	5	71	64	135	154.32	4500	0.00011811
<a href="#">LC-3PT-60</a>	NO.3	23.825	56	78.5	5	83.5	81	164.5	176.37	4500	0.00011811
<a href="#">LC-4PT-60</a>	NO.4	31.267	78	100	6.5	106.5	101.5	208	176.37	4500	0.00011811
<a href="#">LC-5PT-60</a>	NO.5	44.399	98	125	6.5	131.5	129.5	261	507.06	2000	0.00019685
<a href="#">LC-6PT-60</a>	NO.6	63.384	118	154	8	162	182	344	1322.77	1500	0.00019685

※SPECIAL sizes or dimensions are available with quick turnaround

# PT-80 TYPE

※ For PIPE machining  
 ※ Optimal RPM(below 3,800)

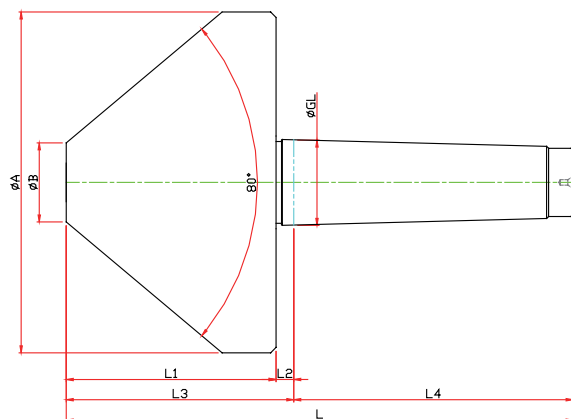

unit:mm/kg

Model	Morse Taper	Dimension								Weight Max. (lbs)	R.P.M Max.	Run out (inch)
		GL	A	B	L1	L2	L3	L4	L			
<a href="#">LC-3PT-80</a>	NO.3	23.825	95	20	66	5	65	81	146	418.88	3800	0.00011811
<a href="#">LC-4PT-80</a>	NO.4	31.267	125	29	77	6.5	83.5	102.5	185	418.88	3800	0.00011811
<a href="#">LC-5PT-80</a>	NO.5	44.399	150	32	90	6.5	96.5	129.5	226	771.62	2000	0.00019685
<a href="#">LC-6PT-80</a>	NO.6	63.384	200	38	120	8	128	182	310	2645.55	1500	0.00019685

※SPECIAL sizes or dimensions are available with quick turnaround

# LM CENTER

- ▶ Full tipped Dead Centers
- ▶ RUN OUT 0.00012"/0.0002" or 0.003mm/0.005mm



## LM-C TYPE

Carbide Type



## LM-AN TYPE

Nut Type



## LM-CN TYPE

Carbide Type, Nut Type



# LM-A TYPE

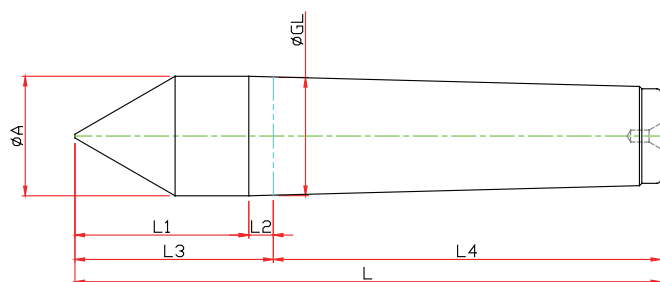

unit:mm/kg

Model	Morse Taper	Dimension							Run out (inch)
		GL	A	L1	L2	L3	L4	L	
<a href="#">LM-1A</a>	NO.1	12,065	12,2	25	3,5	28,5	53,5	82	0,00011811
<a href="#">LM-2A</a>	NO.2	17,780	18	31	5	36	64	100	0,00011811
<a href="#">LM-3A</a>	NO.3	23,825	24	39	5	44	81	125	0,00011811
<a href="#">LM-4A</a>	NO.4	31,267	31,6	46	6,5	52,5	102,5	155	0,00011811
<a href="#">LM-5A</a>	NO.5	44,399	44,7	64	6,5	70,5	129,5	200	0,00011811
<a href="#">LM-6A</a>	NO.6	63,348	63,8	80	8	88	182	270	0,00019685
<a href="#">LM-7A</a>	NO.7	83,058	83,6	105	10	115	250	365	0,00019685

※SPECIAL sizes or dimensions are available with quick turnaround

# LM-C TYPE

※ Carbide Type

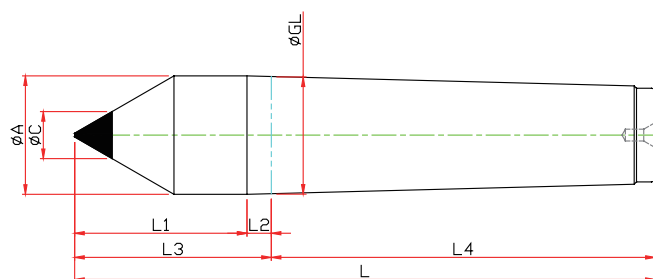

unit:mm/kg

Model	Morse Taper	Dimension								Run out (inch)
		GL	A	L1	L2	L3	L4	C	L	
<a href="#">LM-1C</a>	NO.1	12,065	12,2	25	3,5	28,5	53,5	7	82	0,00011811
<a href="#">LM-2C</a>	NO.2	17,780	18	31	5	36	64	7	100	0,00011811
<a href="#">LM-3C</a>	NO.3	23,825	24	39	5	44	81	10	125	0,00011811
<a href="#">LM-4C</a>	NO.4	31,267	31,6	46	6,5	52,5	102,5	14	155	0,00011811
<a href="#">LM-5C</a>	NO.5	44,399	44,7	64	6,5	70,5	129,5	18	200	0,00011811
<a href="#">LM-6C</a>	NO.6	63,348	63,8	80	8	88	182	25	270	0,00019685
<a href="#">LM-7C</a>	NO.7	83,058	83,6	105	10	115	250	30	365	0,00019685

※SPECIAL sizes or dimensions are available with quick turnaround

# LM-AN TYPE

※ Nut Type

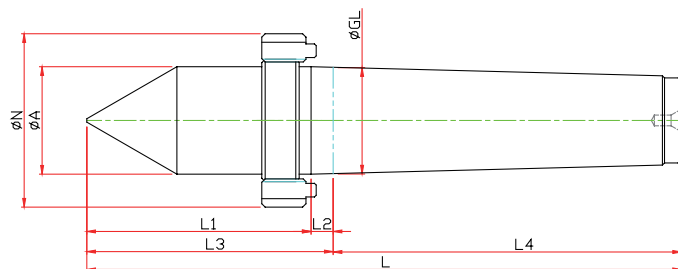

unit:mm/kg

Model	Morse Taper	Dimension								Run out (inch)
		GL	A	L1	L2	L3	L4	N	L	
<a href="#">LM-1AN</a>	NO.1	12,065	12,2	31,5	5	36,5	53,5	M16	90	0,00011811
<a href="#">LM-2AN</a>	NO.2	17,780	18	41,5	6,5	48	64	M22	112	0,00011811
<a href="#">LM-3AN</a>	NO.3	23,825	24	49,5	7,5	57	81	M27	138	0,00011811
<a href="#">LM-4AN</a>	NO.4	31,267	31,6	62,5	10	72,5	102,5	M36	175	0,00011811
<a href="#">LM-5AN</a>	NO.5	44,399	44,7	77	11	88	129,6	M48	217,5	0,00011811
<a href="#">LM-6AN</a>	NO.6	63,348	63,8	96,5	11,5	108	182	M68	290	0,00019685
<a href="#">LM-7AN</a>	NO.7	83,058	83,6	108,5	11,5	120	250	M90	370	0,00019685

※SPECIAL sizes or dimensions are available with quick turnaround

# LM-CN TYPE

※ Carbide, Nut Type

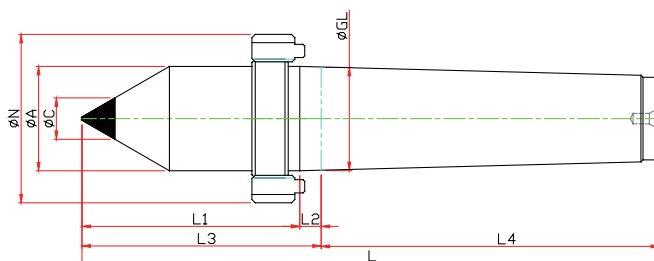

unit:mm/kg

Model	Morse Taper	Dimension									Run out (inch)
		GL	A	L1	L2	L3	L4	C	N	L	
<a href="#">LM-1CN</a>	NO.1	12,065	12	31,5	5	36,5	53,5	7	M16	90	0,00011811
<a href="#">LM-2CN</a>	NO.2	17,780	18	41,5	6,5	48	64	7	M22	112	0,00011811
<a href="#">LM-3CN</a>	NO.3	23,825	24	49,5	7,5	57	81	10	M27	138	0,00011811
<a href="#">LM-4CN</a>	NO.4	31,267	32	62,5	10	72,5	102,5	14	M36	175	0,00011811
<a href="#">LM-5CN</a>	NO.5	44,399	45	77	11	88	129,5	18	M48	217,5	0,00011811
<a href="#">LM-6CN</a>	NO.6	63,348	64	96,5	11,5	108	182	18	M68	290	0,00019685

※SPECIAL sizes or dimensions are available with quick turnaround

# LM SPECIAL

※ Customized-special production for user's condition

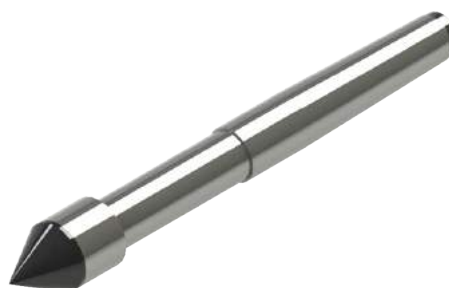



# LM-H CENTER

- ▶ Half tipped Dead Centers
- ▶ Minimize the bite interference
- ▶ RUN OUT 0.00012"/0.0002" or 0.003mm/0.005mm



## LM-HC TYPE

Minimize the bite interference of grindstone  
/ Carbide Type



## LM-HN TYPE

Minimize the bite interference of grindstone  
/ Nut Type



## LM-HCN TYPE

Minimize the bite interference of grindstone  
/ Nut Type



# LM-H TYPE

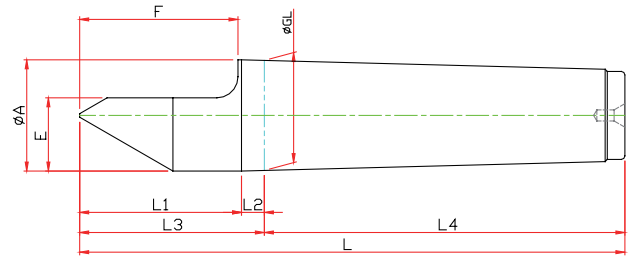

unit:mm/kg

Model	Morse Taper	Dimension									Run out (inch)
		GL	A	L1	L2	L3	L4	E	F	L	
<a href="#">LM-1H</a>	NO.1	12.065	12.2	25	3.5	28.5	53.5	7.6	22	82	0.00011811
<a href="#">LM-2H</a>	NO.2	17.780	18	31	5	36	64	11	30	100	0.00011811
<a href="#">LM-3H</a>	NO.3	23.825	24	39	5	44	81	15	38	125	0.00011811
<a href="#">LM-4H</a>	NO.4	31.267	31.6	46	6.5	52.5	102.5	21	45	155	0.00011811
<a href="#">LM-5H</a>	NO.5	44.399	44.7	64	6.5	70.5	129.5	27.4	63	200	0.00011811
<a href="#">LM-6H</a>	NO.6	63.348	63.8	80	8	88	182	38.9	79	270	0.00019685

※SPECIAL sizes or dimensions are available with quick turnaround

# LM-HC TYPE

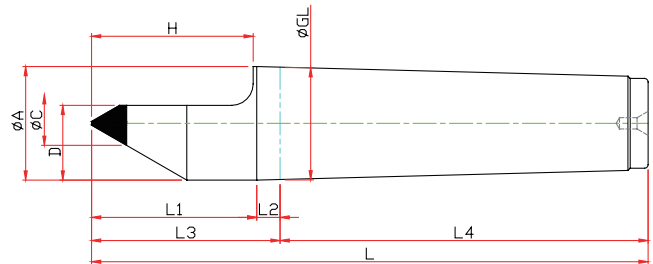

unit:mm/kg

Model	Morse Taper	Dimension										Run out (inch)
		GL	A	L1	L2	L3	L4	C	D	H	L	
<a href="#">LM-1HC</a>	NO.1	12.065	12.2	25	3.5	28.5	53.5	7	7.6	22	82	0.00011811
<a href="#">LM-2HC</a>	NO.2	17.780	18	31	5	36	64	7	11	30	100	0.00011811
<a href="#">LM-3HC</a>	NO.3	23.825	24	39	5	44	81	10	15	38	125	0.00011811
<a href="#">LM-4HC</a>	NO.4	31.267	31.6	46	6.5	52.5	102.5	14	21	45	125	0.00011811
<a href="#">LM-5HC</a>	NO.5	44.399	44.7	64	6.5	70.5	129.5	18	27.4	63	200	0.00011811
<a href="#">LM-6HC</a>	NO.6	63.348	63.8	80	8	88	182	25	38.9	79	270	0.00019685

※SPECIAL sizes or dimensions are available with quick turnaround

# LM-HN TYPE

※ Nut Type

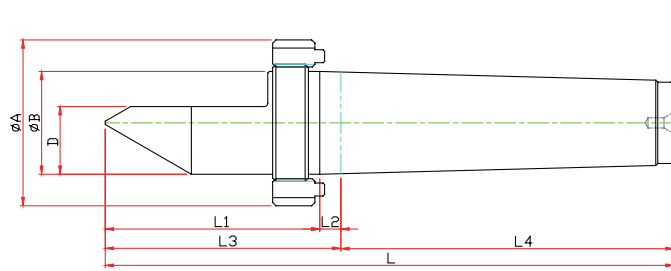

unit:mm/kg

Model	Morse Taper	Dimension										Run out (inch)
		GL	A	L1	L2	L3	L4	D	E	N	L	
<a href="#">LM-1HN</a>	NO.1	12.065	12	31.5	5	36.5	53.5	7.6	22	M16	90	0.00011811
<a href="#">LM-2HN</a>	NO.2	17.780	18	41.5	6.5	48	64	11	30	M22	112	0.00011811
<a href="#">LM-3HN</a>	NO.3	23.825	24	49.5	7.5	57	81	15	38	M27	138	0.00011811
<a href="#">LM-4HN</a>	NO.4	31.267	32	62.5	10	72.5	102.5	21	50	M36	175	0.00011811
<a href="#">LM-5HN</a>	NO.5	44.399	45	77	11	88	129.5	29.4	63	M48	217.5	0.00011811
<a href="#">LM-6HN</a>	NO.6	63.348	64	96.5	11.5	108	182	42	79	M68	290	0.00019685

※SPECIAL sizes or dimensions are available with quick turnaround

# LM-HCN TYPE

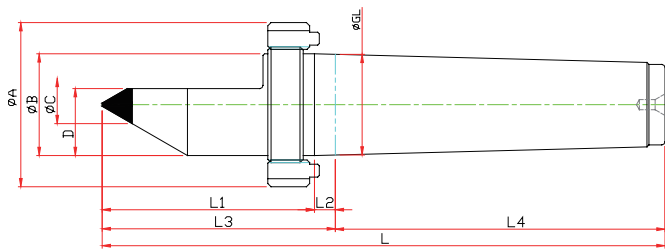

unit:mm/kg

Model	Morse Taper	Dimension											Run out (inch)
		GL	A	L1	L2	L3	L4	C	D	E	N	L	
<a href="#">LM-1HCN</a>	NO.1	12.065	12	31.5	5	36.5	53.5	7	7.6	22	M16	90	0.00011811
<a href="#">LM-2HCN</a>	NO.2	17.780	18	41.5	6.5	48	64	7	11	30	M22	112	0.00011811
<a href="#">LM-3HCN</a>	NO.3	23.825	24	49.5	7.5	57	81	10	15	38	M27	138	0.00011811
<a href="#">LM-4HCN</a>	NO.4	31.267	32	62.5	10	72.5	102.5	14	21	50	M36	175	0.00011811
<a href="#">LM-5HCN</a>	NO.5	44.399	45	77	11	88	129.5	18	29.4	63	M48	217.5	0.00011811
<a href="#">LM-6HCN</a>	NO.6	63.348	64	96.5	11.5	108	182	18	42	79	M68	290	0.00019685

※SPECIAL sizes or dimensions are available with quick turnaround

# LM-H SPECIAL

※ Customized-special production for user's condition



# LM-FN CENTER

- ▶ Spanner Type Dead Center
- ▶ RUN OUT 0.00012"/0.0002" or 0.003mm/0.005mm



## LM-FN TYPE

※ Spanner Type

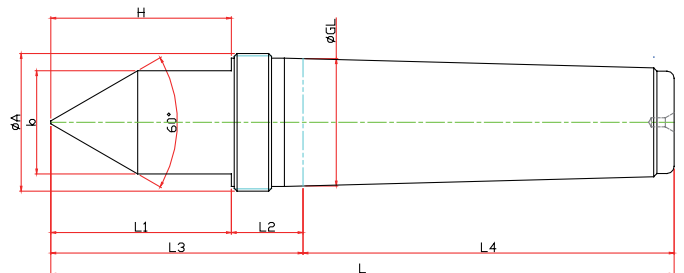

unit:mm/kg

Model	Morse Taper	Dimension									Run out (inch)
		GL	A	b	L1	L2	L3	L4	E	L	
<a href="#">LM-1FN</a>	NO.1	12.065	12.2	10	25	3.5	28.5	53.5	22	82	0,00011811
<a href="#">LM-2FN</a>	NO.2	17.780	18	14	31	5	36	64	30	100	0,00011811
<a href="#">LM-3FN</a>	NO.3	23.825	24	19	39	5	44	81	38	125	0,00011811
<a href="#">LM-4FN</a>	NO.4	31.267	31,6	27	46	6,5	52,5	102,5	50	155	0,00011811
<a href="#">LM-5FN</a>	NO.5	44.399	44,7	36	64	6,5	70,5	129,5	53	200	0,00011811

※SPECIAL sizes or dimensions are available with quick turnaround

# LM-#80 TYPE

- ▶ 1/10 Taper Dead Center with detachable nut
- ▶ RUN OUT 0.0002" or 0.005mm



## LM-#80 TYPE

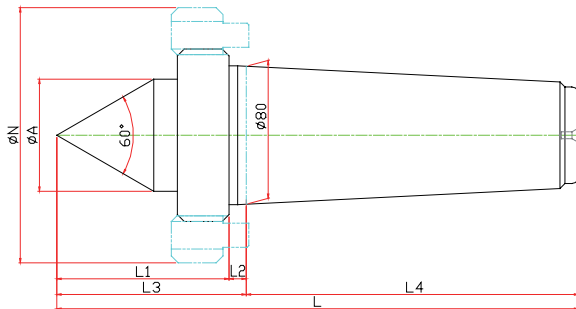

unit:mm/kg

Model	Morse Taper	Dimension									Run out (inch)
		GL	A	b	L1	L2	L3	L4	E	L	
#80-60	1/10 TAPER	80	65	148	70	30	10	110	193	303	0.00019685
#80-75	1/10 TAPER	80	65	148	70	30	10	110	193	303	0.00019685

※SPECIAL sizes or dimensions are available with quick turnaround

# FLANGE CENTER

- ▶ Flange Bolt Clamping Type
- ▶ Heavy duty with very high accuracy
- ▶ SPECIAL sizes or dimensions are available with quick turnaround
- ▶ Maximum Concentricity Error 0.0002" or 0.005mm



## LM-G TYPE *New*

※ Flange Bolt Clamping Type

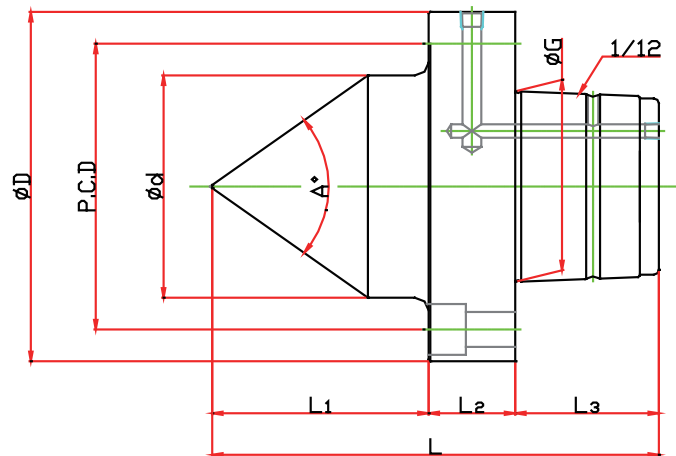

unit:mm/kg

Model	Morse Taper	Dimension									MAX. Con Error
		A	G	d	D	P.C.D	L1	L2	L3	L	
<a href="#">LM-#80-60</a>	1/12	60	80	85	135	103	90	30	80	200	0.00019685
<a href="#">LM-#80-75</a>		75	80	85	135	103	90	30	80	200	
<a href="#">LM-#80-90</a>		90	80	85	135	103	90	30	80	200	
<a href="#">LM-#100-60</a>	1/12	60	100	100	155	125	107	40	83	230	
<a href="#">LM-#100-75</a>		75	100	100	155	125	107	40	83	230	
<a href="#">LM-#100-90</a>		90	100	100	155	125	107	40	83	230	
<a href="#">LM-#120-60</a>	1/12	60	120	120	195	150	147	40	83	270	
<a href="#">LM-#120-75</a>		75	120	120	195	150	147	40	83	270	
<a href="#">LM-#120-90</a>		90	120	120	195	150	147	40	83	270	

※SPECIAL sizes or dimensions are available with quick turnaround

# FACE DRIVE

- ▶ Chuck Clamp
- ▶ Used in operations where a Chuck is not possible or efficient



## FDC TYPE *New*

※ Chuck Clamp

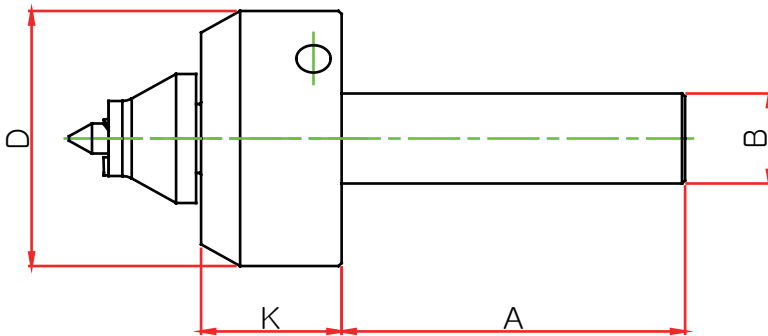

Model	ORDER No.	Morse Taper	Dimensions				Run out (inch)
			A	B	D	K	
<u>FDC</u>	700103		110	30	85	45	

※SPECIAL sizes or dimensions are available with quick turnaround





[www.widinus.com\(US\)](http://www.widinus.com(US))  
[www.iwidin.com\(KR\)](http://www.iwidin.com(KR))

# LIVE CENTER

LIVE CENTER  
LATHE CENTER  
SPECIAL LIVE CENTER

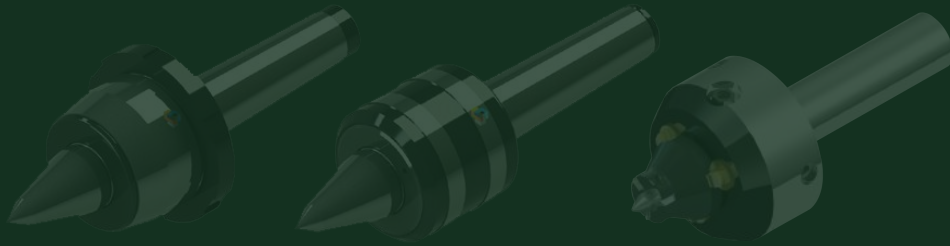

**Chicago Office (WIDIN. INC.)**  
1261 Wiley Rd. Unit F., Schaumburg, IL 60173

TEL. 1. 847. 947. 8320  
TOLL FREE. 1. 877. 947. 0989  
FAX. 1. 847. 947. 8322  
Email. [customerservice@widinus.com](mailto:customerservice@widinus.com)