



15150 – 25th Avenue North, Minneapolis, MN 55447-1981
 Phone 763-476-8600 Fax 763-476-4092
 Service Dept: (MN) 763-476-4191 (IA) 319-632-4288 (NE) 402-330-2323
 Visit us at: www.productivity.com Productivity is ISO 9001:2000 Certified

Productivity Inc®

PIC Nakamura SC-300 Pre-Installation Checklist – Rev 06/2009

Installation of your new Nakamura SC-300 can be smooth and rapid if preparations are made prior to the delivery of your machine. Any questions regarding machine installation should be directed to our service department for clarification. We hope this checklist will aid in a rapid installation of your new machine. **The following must be completed prior to our service technician arriving to install the machine.**

- Power Requirements for your machine: *208-220v/3 phase/40 kVa Amperage: 101 Amps at 220v Proper voltage per machine specifications should be ready at machine site. **Do NOT power up the machine. *NOTE: 220v minimum, 240v maximum. Voltage in excess of 240v may cause extensive damage to the machine’s electrical system and will void the machine’s warranty. All Methods Slant Turning enters require a minimum of 6’ copper earth ground located as close as possible to the machine grounding terminal.**
- Customer should furnish and have available the proper supply and types of lubricants required for machine operation.

ITEM	CAPACITY	FLUID TYPE
Coolant	40 Gal	Water Soluable, Synthetic
Way Lube	1 Gal	Mobil Vactra #2
Hydraulic Oil	12 Gal	Mobil DTE 24

You will need to have these lubricants on hand at time of installation. Contact our Service Department with any questions or concerns regarding Power and/or Lubrication Requirements.

- Air lines should be routed to the machine location and operational for proper air pressure.

Environment: Temperature 50-95 degrees, with 75% Maximum Relative Humidity.

- Machine location should be planned to allow enough room for access panels to be opened and serviced with ease. *Allow an extra 36” behind the machine for maintenance, and an additional 48” to the right side of the machine if optional Chip Conveyor is purchased.*
- Weight requirements should be checked to insure that the surface below the machine will have sufficient strength for support and stability. The machine must be set on a solid, sound and stable, steel bar-reinforced concrete slab poured directly on the grade. In general, the 6-12” concrete floor on industrial buildings is suitable for machine placement. Bolting the machine to the floor is not required.
- **The Nakamura SC300 Lathe is best moved with a forklift.** Upon *Upon arrival of your machine, unpack and immediately check for visible damage. Call Hope immediately – you will need to take pictures and email to hriska@productivity.com. Make sure you note on BOL BEFORE the driver leaves.*

SHIPPING WEIGHT	SHIPPING DIMENSIONS OF MACHINE
10,340# (Machine & Accessory Crate) 1,500# (Opt Chip Conveyor)	10’6” L x 5’8” W x 6’5” H (2 pieces – Machine and Accessory Crate) 124” L x 36” W x 68” H (Optional Chip Conveyor, skidded)
<i>Operational Dimensions (Floor Space): 153” L x 145” W (w/out Chip Conveyor) Add an additional 48” to the right side of the machine length for optional Chip Conveyor.</i>	

- **Remove as much preservative from the machine as possible without having to power up (tables – slides, pulleys, etc.). We recommend mineral spirits to clean. Apply oil when finished to prevent rust.**

PLEASE FORWARD THIS TO THE APPROPRIATE PERSON. THANK YOU.

■ Standard specification

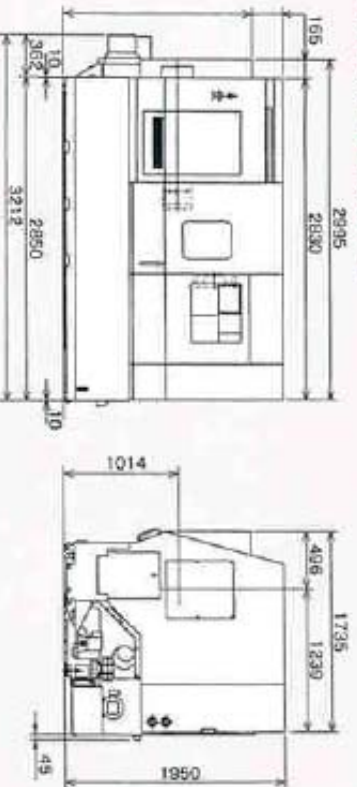

■ Sub spindle specification

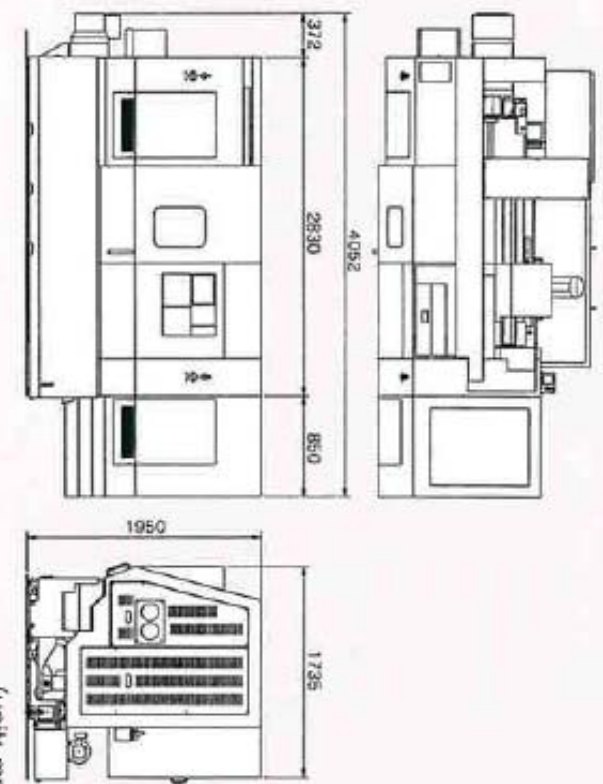

■ Y-axis specification

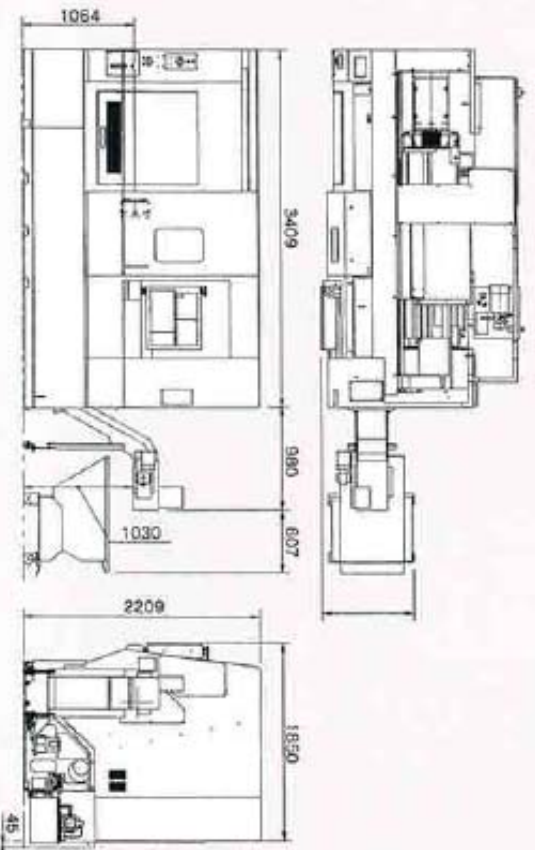

● The dimension is subject to change depending on the specifications.

(Unit: mm)

Table 4-9 Recommended Oil Table

Maker	Lubricating Oil	Hydraulic Oil	Grease		Lubricating Oil
	VG68	VG32			VG320
Idemitsu	Daphne Super Multi Oil 68	Daphne Super Multi Oil 32	Daphne Molybdenum grease	Daphne Super Coronex No.2	Daphne Super Gear Oil 320
Shell	Tonna Oil T68 or A-R Oil 68	Tellus Oil C32 or J-H Oil 32	Lethinax AM or Sunlight grease MB2	Alvania Grease 2 or Sunlight Grease 2	Omala Oil 320 or G-C Oil 320SE
Mobil	Mobil Vactra Oil No. 2	Mobil DTE Oil Light	Mobil Grease Special	Mobil Mobilux 2	Mobil Gear 632
Mitsubishi	Diamond slide-way 68	Diamond Lub RO32	Diamond Multi purpose M grease 2	Diamond Multi Purpose grease No.2	Diamond gear Lub 320
Fuji	Lubmulti 68	Lubmulti 32		Mighty grease No.2	Mild EP Gear 320
Nisseki	Uniway 68	FBK Oil R032	Molynoc grease 2	Multinoc grease 2	Bonnoc SP320
Cosmo	Mightyway 68	Hydro RO32	Molybdenum grease	Grease Dynamax Super No.2	Cosmo gear SE320
Exxon	Febis K68	Terreso 32	Beacon Q2	Lithtan 2	Spartan EP320
Kygnus	Waylubricant 80	Unit Oil P32	M-5 Grease No. 2	MP Grease No. 2	
Kyodo	Slidus 68	RIX turbine 32	Lisonix grease M-2	Lisonix grease 2	Reductus 320
General	Slideoil 68	General panol 32	Gemico grease AD-2	Gemico grease MP-2	SP GEAROL 320
Mitsui	Slideway E68	Hydic oil 32		Multi grease EP-2	Mild gear EP320
NOK Fleuber			Multemp Q NB50		
Three bond			Three bond 1901		
Castrol	Magnaglide BD68	Hyspin AWS32	Spherol LMM	Spherol AP2	Alpha SP320
Remark (Oiling drive Point)	Centralized lubricating oil tank	Hydraulic oil tank	Jaw chuck	Rotary tool holder C-axis spline	C-axis harmonic drive

5. TOOLING
5-1 Spindle Nose Dimensions (A1-8)

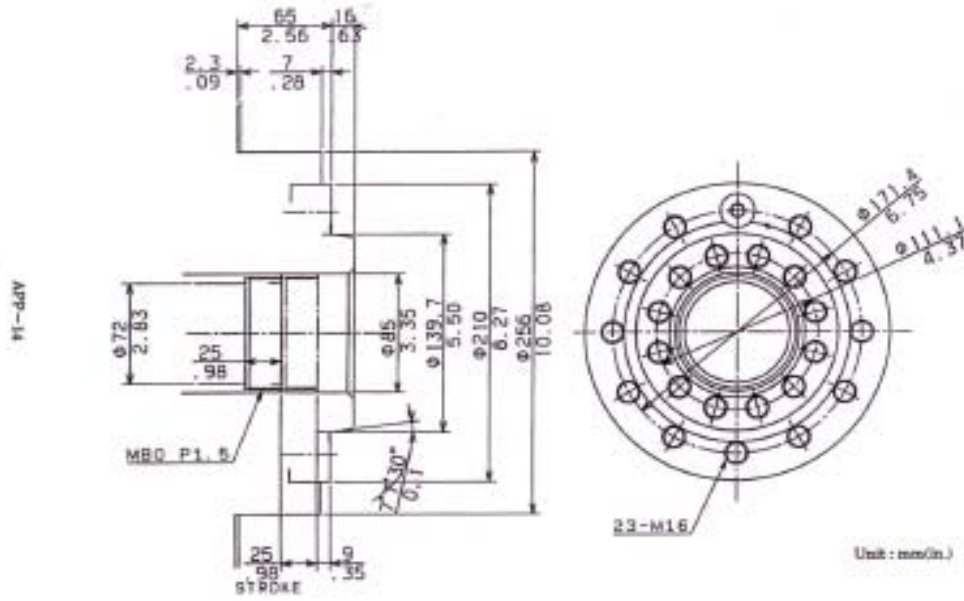

APPENDIX

3-2 Foundation Plan

